

Bowdoin

Map Lot 05-64-0

Account 546

Location 1019 MAIN ST

Card 1 Of 1 7/19/2022

Building Style 4 Cape Cod	SF Bsmt Living 0	Layout 1 Typical
0.Not Code 4.Cape 8.Log	Fin Bsmt Grade 0 0	1.Typical 4. 7.
1.Conv. 5.Garrison 9.Other	OCCUPANCY 0	2.Inadeq 5. 8.
2.Ranch 6.Split 10.DW	Heat Type 100% 5 Forced Warm Air	3.Poor 6. 9.
3.R Ranch 7.Contemp 11.Church	0.Not Code 4.Steam 8.FI/Wall	Attic 9 None
Dwelling Units 1	1.HWBB 5.FWA 9.No Heat	1.1/4 Fin 4.Full Fin 7.
Other Units 0	2.HWCI 6.GravWA 11.	2.1/2 Fin 5.FI/Stair 8.
Stories 4 One & 1/2 Story	3.H Pump 7.Electric 12.	3.3/4 Fin 6. 9.None
1.1 4.1.5 7.4	Cool Type 0% 9 None	Insulation 1 Full
2.2 5.1.75 8.20	1.Refrig 4.W&C Air 7.	1.Full 4.Minimal 7.
3.3 6.2.5 9.Yurt	2.Evapor 5. 8.	2.Heavy 5. 8.
Exterior Walls 2 Vinyl/Aluminum	3.H Pump 6. 9.None	3.Capped 6. 9.None
0.Not Code 4.Asbestos 8.Concrete	Kitchen Style 2 Typical	Unfinished % 0%
1.Wood 5.Stucco 9.Other	1.Modern 4.Obsolete 7.	Grade & Factor 2 Fair 105%
2.Vin/Al 6.Brick 10.Board B	2.Typical 5. 8.	1.E Grade 4.B Grade 7.
3.Compos. 7.Stone 12.	3.Old Type 6. 9.None	2.D Grade 5.A Grade 8.
Roof Surface 1 Asphalt Shingles	Bath(s) Style 2 Typical Bath(s)	3.C Grade 6.AA Grade 9.Same
1.Asphalt 4.Composit 7.	1.Modern 4.Obsolete 7.	SQFT (Footprint) 425
2.Slate 5.Wood 8.	2.Typical 5. 8.	Condition 4 Average
3.Metal 6.Other 9.	3.Old Type 6. 9.None	1.Poor 4.Avg 7.V G
SF Masonry Trim 0	# Rooms 9	2.Fair 5.Avg+ 8.Exc
SEPTIC DESIGN 0	# Bedrooms 3	3.Avg- 6.Good 9.Same
BLDG PERMIT 0	# Full Baths 1	Phys. % Good 0%
Year Built 1950	# Half Baths 0	Funct. % Good 100%
Year Remodeled 0	# Addn Fixtures 0	Functional Code 9 None
Foundation 1 Concrete	# Fireplaces 1	1.Incomp 4.Delap 7.No Power
1.Concrete 4.Wood 7.	 <p>TRIO Software A Division of Harris Computer Systems</p>	2.O-Built 5.Bsmt 8.LongTerm
2.C Block 5.Slab 8.		3.Damage 6.Dbwld 9.None
3.Br/Stone 6.Piers 9.		Econ. % Good 100%
Basement 2 1/2 Basement		Economic Code None
1.1/4 Bmt 4.Full Bmt 7.		0.None 3.No Power 7.
2.1/2 Bmt 5.None 8.		1.Location 4.Generate 8.
3.3/4 Bmt 6. 9.None		2.Encroach 9.None 9.
Bsmt Gar # Cars 0		Entrance Code 5 Estimated
Wet Basement 0		1.Interior 4.Vacant 7.Entered
1.Dry 4. 7.		2.Refusal 5.Estimate 8.No
2.Damp 5. 8.	3.Informed 6.Reviewed 9.Land	
3.Wet 6. 9.	Information Code 5 Estimate	
	1.Owner 4.Agent 7.	
	2.Relative 5.Estimate 8.	
	3.Tenant 6.Other 9.	

Date Inspected 4/20/2015

Additions, Outbuildings & Improvements

Type	Year	Units	Grade	Cond	Phys.	Funct.	Sound Value
1 One Story Frame	1950	404	2 105	4	0 %	100 %	
1 One Story Frame	1950	224	2 105	4	0 %	100 %	
68 Wood Deck	1990	532	3 100	4	0 %	100 %	
30 Detached Garage	1960	280	2 100	2	0 %	100 %	
30 Detached Garage	1988	672	3 100	4	0 %	100 %	
49 Storage space	1988	336	3 100	4	0 %	100 %	
					%	%	
					%	%	
					%	%	
					%	%	

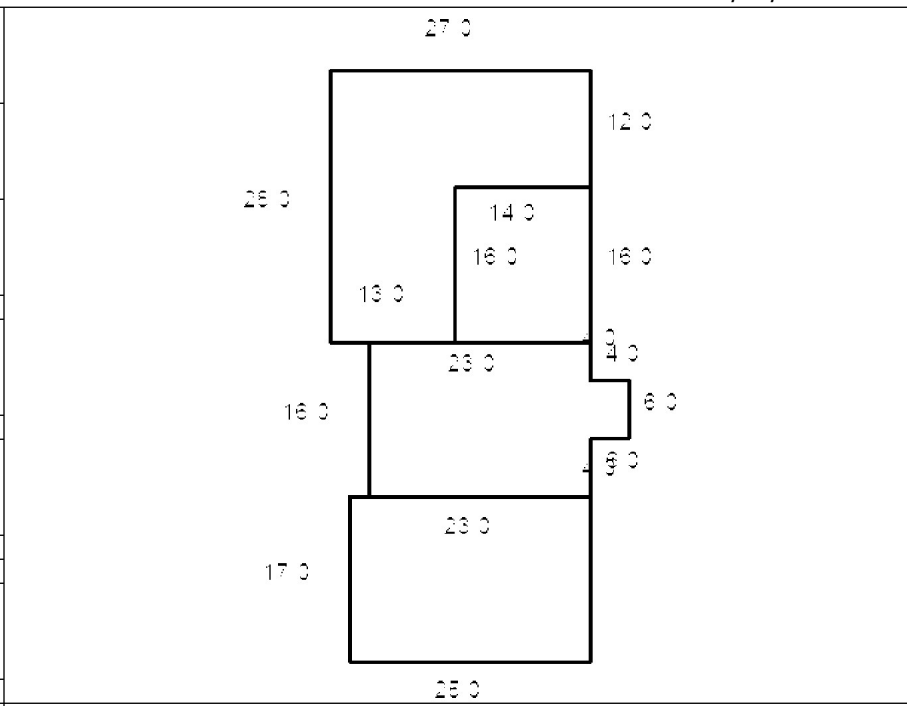

OCT 26 2006

Bowdoin

Map Lot 05-64-01

Account 547

Location 995 MAIN ST

Card 1 Of 1 7/19/2022

Building Style 0 Not Coded	SF Bsmt Living 0	Layout 0
0.Not Code 4.Cape 8.Log	Fin Bsmt Grade 0 0	1.Typical 4. 7.
1.Conv. 5.Garrison 9.Other	OCCUPANCY 0	2.Inadeq 5. 8.
2.Ranch 6.Split 10.DW	Heat Type 100% 0 Not Coded	3.Poor 6. 9.
3.R Ranch 7.Contemp 11.Church	0.Not Code 4.Steam 8.FI/Wall	Attic 0
Dwelling Units 1	1.HWBB 5.FWA 9.No Heat	1.1/4 Fin 4.Full Fin 7.
Other Units 0	2.HWCI 6.GravWA 11.	2.1/2 Fin 5.FI/Stair 8.
Stories 0	3.H Pump 7.Electric 12.	3.3/4 Fin 6. 9.None
1.1 4.1.5 7.4	Cool Type 0% 9 None	Insulation 0
2.2 5.1.75 8.20	1.Refrig 4.W&C Air 7.	1.Full 4.Minimal 7.
3.3 6.2.5 9.Yurt	2.Evapor 5. 8.	2.Heavy 5. 8.
Exterior Walls 0 Not Coded	3.H Pump 6. 9.None	3.Capped 6. 9.None
0.Not Code 4.Asbestos 8.Concrete	Kitchen Style 0	Unfinished % 0%
1.Wood 5.Stucco 9.Other	1.Modern 4.Obsolete 7.	Grade & Factor 0 100%
2.Vin/Al 6.Brick 10.Board B	2.Typical 5. 8.	1.E Grade 4.B Grade 7.
3.Compos. 7.Stone 12.	3.Old Type 6. 9.None	2.D Grade 5.A Grade 8.
Roof Surface 0	Bath(s) Style 0	3.C Grade 6.AA Grade 9.Same
1.Asphalt 4.Composit 7.	1.Modern 4.Obsolete 7.	SQFT (Footprint) 0
2.Slate 5.Wood 8.	2.Typical 5. 8.	Condition 0
3.Metal 6.Other 9.	3.Old Type 6. 9.None	1.Poor 4.Avg 7.V G
SF Masonry Trim 0	# Rooms 0	2.Fair 5.Avg+ 8.Exc
SEPTIC DESIGN 0	# Bedrooms 0	3.Avg- 6.Good 9.Same
BLDG PERMIT 1736	# Full Baths 1	Phys. % Good 0%
Year Built 0	# Half Baths 0	Funct. % Good 100%
Year Remodeled 0	# Addn Fixtures 0	Functional Code 9 None
Foundation 0	# Fireplaces 0	1.Incomp 4.Delap 7.No Power
1.Concrete 4.Wood 7.		2.O-Built 5.Bsmt 8.LongTerm
2.C Block 5.Slab 8.		3.Damage 6.Dbwd 9.None
3.Br/Stone 6.Piers 9.		Econ. % Good 100%
Basement 0		Economic Code None
1.1/4 Bmt 4.Full Bmt 7.		0.None 3.No Power 7.
2.1/2 Bmt 5.None 8.		1.Location 4.Generate 8.
3.3/4 Bmt 6. 9.None		2.Encroach 9.None 9.
Bsmt Gar # Cars 0		Entrance Code 5 Estimated
Wet Basement 0		1.Interior 4.Vacant 7.Entered
1.Dry 4. 7.		2.Refusal 5.Estimate 8.No
2.Damp 5. 8.		3.Informed 6.Reviewed 9.Land
3.Wet 6. 9.		Information Code 5 Estimate
		1.Owner 4.Agent 7.
		2.Relative 5.Estimate 8.
		3.Tenant 6.Other 9.



Date Inspected 3/27/2019

Additions, Outbuildings & Improvements

Type	Year	Units	Grade	Cond	Phys.	Funct.	Sound Value
68 Wood Deck	0	240	0 0	0	0 %	0 %	
68 Wood Deck	0	126	0 0	0	0 %	0 %	
68 Wood Deck	0	247	0 0	0	0 %	0 %	
30 Detached Garage	1995	1040	3 100	4	0 %	100 %	
992 Doublewide	1993	24x40	3 100	4	0 %	100 %	
27 Unfin Basement	1993	960	3 100	4	0 %	100 %	
11 One	2017	322	3 100	3	0 %	100 %	
					%	%	
					%	%	
					%	%	
					%	%	

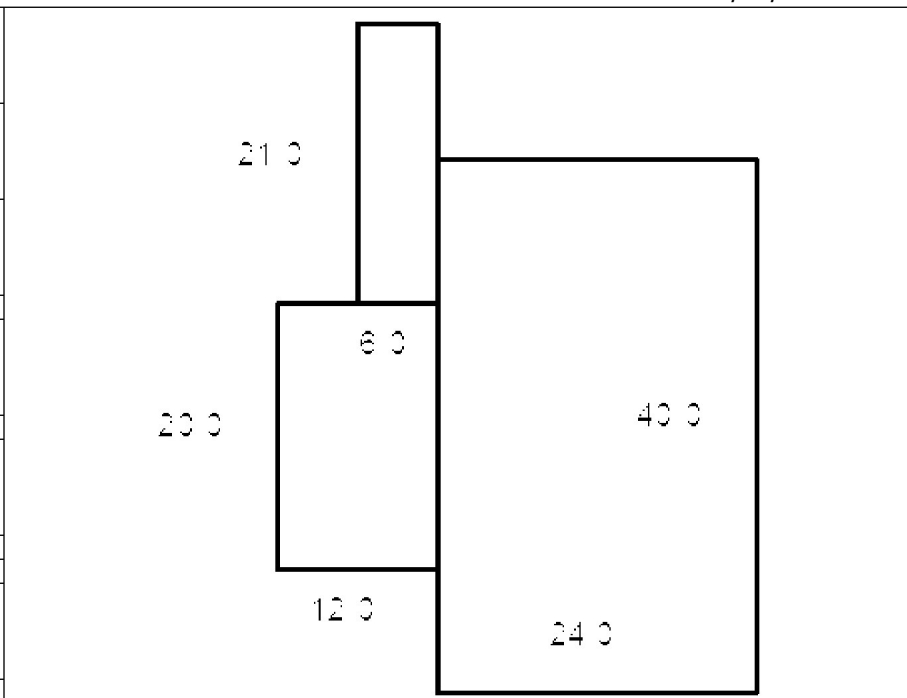

BURNHAM, MELODIE J
BURNHAM, STANLEY D
995 MAIN ST
BOWDOIN ME 04287

B2018RP6413

Inspection Witnessed By:

No./Date	Description	Date Insp.
X		

Notes:

Bowdoin

Property Data			Assessment Record							
Neighborhood 5 Map 5			Year	Land	Buildings	Exempt	Total			
Tree Growth Year 0			2019	11,430	0	0	11,430			
Farmland Yr 0			2020	11,430	0	0	11,430			
Open Space Yr 0			2021	11,430	0	0	11,430			
Zone/Land Use 11 Residential 1			2022	11,430	0	0	11,430			
Secondary Zone										
Topography										
1.Level 4.Below St 7.LevelBog 2.Rolling 5.Low 8.Conform 3.Above St 6.FZone 9.Non-Confor										
Utilities										
1.Public 4.Dr Well 7.Cesspool 2.Water 5.Dug Well 8. 3.Sewer 6.Septic 9.None										
Street 1 Paved										
1.Paved 4.Proposed 7.MHG 2.Semi Imp 5.R/O/W 8.DIS 3.Gravel 6.MHP 9.None										
TG PLAN YEAR 0										
Tif District # 0										
Sale Data			Land Data							
Sale Date 8/30/2018			Front Foot	Type	Effective		Influence		Influence Codes	
Price					Frontage	Depth	Factor	Code		
Sale Type 1 Land Only				11.Road Frontage						1.Unimproved
1.Land 4.Mobile 7.C/I L&B				12.Delta Triangle						2.Excess Frtg
2.L & B 5.Other 8.				13.Nabla Triangle						3.Topography
3.Building 6.C/I Land 9.			14.Rear Land					4.Size/Shape		
Financing 9 Unknown			15.Miscellaneous					5.Access		
1.Convent 4.Seller 7.			Square Foot	Square Feet				6.Restriction		
2.FHA/VA 5.Private 8.				16.Regular Lot				7.Open Space		
3.Assumed 6.Cash 9.Unknown				17.Secondary Lot				8.View/Environ		
Validity 2 Related Parties				18.Hydro Facility				9.Fract Share		
1.Valid 4.Split 7.Renovate				19.Improvements				30.Rear Land 3		
2.Related 5.Partial 8.Other			20.Base 3 (Fract)				31.Tillable			
3.Distress 6.Exempt 9.Short			Fract. Acre	Acres/Sites				32.Pasture		
Verified 5 Public Record				21.Base 1 (Fract)	23	1.00	100 %	0	33.Orchard	
1.Buyer 4.Agent 7.Family				22.Base 2 (Fract)	28	1.02	100 %	0	34.Softwood F&O	
2.Seller 5.Pub Rec 8.Other				23.Base 3	52	195.00	100 %	0	35.Mixed Wood F&O	
3.Lender 6.MLS 9.				Acres					36.Hardwood F&O	
			24.Base 1					37.Softwood TG		
			25.Base 2					38.Mixed Wood TG		
			26.Frontage 1					39.Hardwood TG		
			27.Rear Land 4					40.Wasteland		
			28.Rear Land 1					41.Commercial		
			29.Rear Land 2					42.2nd Site		
			Total Acreage		2.02			43.Post Rd		
								44.Lot Improvemen		
								45.Subdivision Lo		
								46.Golf Course		

Bowdoin

Map Lot 05-64-02

Account 1915

Location MAIN ST

Card 1 Of 1 7/19/2022

Building Style	SF Bsmt Living	Layout
0.Not Code 4.Cape 8.Log	Fin Bsmt Grade	1.Typical 4. 7.
1.Conv. 5.Garrison 9.Other	OCCUPANCY	2.Inadeq 5. 8.
2.Ranch 6.Split 10.DW	Heat Type 100%	3.Poor 6. 9.
3.R Ranch 7.Contemp 11.Church	0.Not Code 4.Steam 8.Fi/Wall	Attic
Dwelling Units	1.HWBB 5.FWA 9.No Heat	1.1/4 Fin 4.Full Fin 7.
Other Units	2.HWCI 6.GravWA 11.	2.1/2 Fin 5.Fi/Stair 8.
Stories	3.H Pump 7.Electric 12.	3.3/4 Fin 6. 9.None
1.1 4.1.5 7.4	Cool Type 0%	Insulation
2.2 5.1.75 8.20	1.Refrig 4.W&C Air 7.	1.Full 4.Minimal 7.
3.3 6.2.5 9.Yurt	2.Evapor 5. 8.	2.Heavy 5. 8.
Exterior Walls	3.H Pump 6. 9.None	3.Capped 6. 9.None
0.Not Code 4.Asbestos 8.Concrete	Kitchen Style	Unfinished %
1.Wood 5.Stucco 9.Other	1.Modern 4.Obsolete 7.	Grade & Factor
2.Vin/Al 6.Brick 10.Board B	2.Typical 5. 8.	1.E Grade 4.B Grade 7.
3.Compos. 7.Stone 12.	3.Old Type 6. 9.None	2.D Grade 5.A Grade 8.
Roof Surface	Bath(s) Style	3.C Grade 6.AA Grade 9.Same
1.Asphalt 4.Composit 7.	1.Modern 4.Obsolete 7.	SQFT (Footprint)
2.Slate 5.Wood 8.	2.Typical 5. 8.	Condition
3.Metal 6.Other 9.	3.Old Type 6. 9.None	1.Poor 4.Avg 7.V G
SF Masonry Trim	# Rooms	2.Fair 5.Avg+ 8.Exc
SEPTIC DESIGN	# Bedrooms	3.Avg- 6.Good 9.Same
BLDG PERMIT	# Full Baths	Phys. % Good
Year Built	# Half Baths	Funct. % Good
Year Remodeled	# Addn Fixtures	Functional Code
Foundation	# Fireplaces	1.Incomp 4.Delap 7.No Power
1.Concrete 4.Wood 7.		2.O-Built 5.Bsmt 8.LongTerm
2.C Block 5.Slab 8.		3.Damage 6.Dbwd 9.None
3.Br/Stone 6.Piers 9.		Econ. % Good
Basement		Economic Code
1.1/4 Bmt 4.Full Bmt 7.		0.None 3.No Power 7.
2.1/2 Bmt 5.None 8.		1.Location 4.Generate 8.
3.3/4 Bmt 6. 9.None		2.Encroach 9.None 9.
Bsmt Gar # Cars		Entrance Code 0
Wet Basement		1.Interior 4.Vacant 7.Entered
1.Dry 4. 7.		2.Refusal 5.Estimate 8.No
2.Damp 5. 8.	3.Informed 6.Reviewed 9.Land	
3.Wet 6. 9.	Information Code 0	
	1.Owner 4.Agent 7.	
	2.Relative 5.Estimate 8.	
	3.Tenant 6.Other 9.	

Date Inspected

Additions, Outbuildings & Improvements

Type	Year	Units	Grade	Cond	Phys.	Funct.	Sound Value
					%	%	1.One Story Fram
					%	%	2.Two Story Fram
					%	%	3.Three Story Fr
					%	%	4.1 & 1/2 Story
					%	%	5.1 & 3/4 Story
					%	%	6.2 & 1/2 Story
					%	%	21.Open Frame Por
					%	%	22.Encl Frame Por
					%	%	23.Attached Garag
					%	%	24.Frame Shed
					%	%	25.Frame Bay Wind
					%	%	26.1SFr Overhang
					%	%	27.Unfin Basement
					%	%	28.Unfinished Att
					%	%	29.Finished Attic

BURNHAM, ADAM D
BURNHAM, BRITTANY D
1013 MAIN ST
BOWDOIN ME 04287

B2018RP6412

Inspection Witnessed By:

No./Date	Description	Date Insp.
X		

Notes:

Bowdoin

Property Data			Assessment Record						
Neighborhood 5 Map 5			Year	Land	Buildings	Exempt	Total		
Tree Growth Year 0			2019	44,050	28,360	0	72,410		
Farmland Yr 0			2020	51,550	215,720	0	267,270		
Open Space Yr 0			2021	51,550	215,720	0	267,270		
Zone/Land Use 11 Residential 1			2022	51,550	215,720	0	267,270		
Secondary Zone									
Topography									
1.Level 4.Below St 7.LevelBog 2.Rolling 5.Low 8.Conform 3.Above St 6.FZone 9.Non-Confor									
Utilities									
1.Public 4.Dr Well 7.Cesspool 2.Water 5.Dug Well 8. 3.Sewer 6.Septic 9.None									
Street 1 Paved									
1.Paved 4.Proposed 7.MHG 2.Semi Imp 5.R/O/W 8.DIS 3.Gravel 6.MHP 9.None									
TG PLAN YEAR 0									
Tif District # 0									
Sale Data			Land Data						
Sale Date 8/30/2018			Front Foot	Type	Effective		Influence		Influence Codes
Price					Frontage	Depth	Factor	Code	
Sale Type 1 Land Only				11.Road Frontage			%		
1.Land 4.Mobile 7.C/I L&B				12.Delta Triangle			%		
2.L & B 5.Other 8.				13.Nabla Triangle			%		
3.Building 6.C/I Land 9.			14.Rear Land			%			
Financing 9 Unknown			15.Miscellaneous			%			
1.Convent 4.Seller 7.			Square Foot	Square Feet					
2.FHA/VA 5.Private 8.				16.Regular Lot			%		
3.Assumed 6.Cash 9.Unknown				17.Secondary Lot			%		
Validity 2 Related Parties				18.Hydro Facility			%		
1.Valid 4.Split 7.Renovate				19.Improvements			%		
2.Related 5.Partial 8.Other			20.Base 3 (Fract)			%			
3.Distress 6.Exempt 9.Short			Fract. Acre	Acres/Sites					
Verified 5 Public Record				21.Base 1 (Fract)	24	1.00	100 %	0	
1.Buyer 4.Agent 7.Family				22.Base 2 (Fract)	28	2.89	100 %	0	
2.Seller 5.Pub Rec 8.Other				23.Base 3	52	175.00	100 %	0	
3.Lender 6.MLS 9.				Acres	44	1.00	100 %	0	
			24.Base 1				%		
			25.Base 2				%		
			26.Frontage 1				%		
			27.Rear Land 4				%		
			28.Rear Land 1	Total Acreage		3.89			
			29.Rear Land 2						

- 1.Unimproved
- 2.Excess Frtg
- 3.Topography
- 4.Size/Shape
- 5.Access
- 6.Restriction
- 7.Open Space
- 8.View/Environ
- 9.Fract Share
- Acres**
- 30.Rear Land 3
- 31.Tillable
- 32.Pasture
- 33.Orchard
- 34.Softwood F&O
- 35.Mixed Wood F&O
- 36.Hardwood F&O
- 37.Softwood TG
- 38.Mixed Wood TG
- 39.Hardwood TG
- 40.Wasteland
- 41.Commercial
- 42.2nd Site
- 43.Post Rd
- 44.Lot Improvemen
- 45.Subdivision Lo
- 46.Golf Course

Bowdoin

Map Lot 05-64-03

Account 1916

Location 1013 MAIN ST

Card 1 Of 1 7/19/2022

Building Style 2 Ranch	SF Bsmt Living 0	Layout 1 Typical
0.Not Code 4.Cape 8.Log	Fin Bsmt Grade 0 0	1.Typical 4. 7.
1.Conv. 5.Garrison 9.Other	OCCUPANCY 0	2.Inadeq 5. 8.
2.Ranch 6.Split 10.DW	Heat Type 100% 5 Forced Warm Air	3.Poor 6. 9.
3.R Ranch 7.Contemp 11.Church	0.Not Code 4.Steam 8.F/Wall	Attic 4 Full Finished
Dwelling Units 1	1.HWBB 5.FWA 9.No Heat	1.1/4 Fin 4.Full Fin 7.
Other Units 0	2.HWCI 6.GravWA 11.	2.1/2 Fin 5.F/Stair 8.
Stories 1 One Story	3.H Pump 7.Electric 12.	3.3/4 Fin 6. 9.None
1.1 4.1.5 7.4	Cool Type 0% 9 None	Insulation 1 Full
2.2 5.1.75 8.20	1.Refrig 4.W&C Air 7.	1.Full 4.Minimal 7.
3.3 6.2.5 9.Yurt	2.Evapor 5. 8.	2.Heavy 5. 8.
Exterior Walls 2 Vinyl/Aluminum	3.H Pump 6. 9.None	3.Capped 6. 9.None
0.Not Code 4.Asbestos 8.Concrete	Kitchen Style 1 Modern	Unfinished % 0%
1.Wood 5.Stucco 9.Other	1.Modern 4.Obsolete 7.	Grade & Factor 4 Good 100%
2.Vin/Al 6.Brick 10.Board B	2.Typical 5. 8.	1.E Grade 4.B Grade 7.
3.Compos. 7.Stone 12.	3.Old Type 6. 9.None	2.D Grade 5.A Grade 8.
Roof Surface 1 Asphalt Shingles	Bath(s) Style 1 Modern Bath(s)	3.C Grade 6.AA Grade 9.Same
1.Asphalt 4.Composit 7.	1.Modern 4.Obsolete 7.	SQFT (Footprint) 1456
2.Slate 5.Wood 8.	2.Typical 5. 8.	Condition 4 Average
3.Metal 6.Other 9.	3.Old Type 6. 9.None	1.Poor 4.Avg 7.V G
SF Masonry Trim 0	# Rooms 0	2.Fair 5.Avg+ 8.Exc
SEPTIC DESIGN 0	# Bedrooms 3	3.Avg- 6.Good 9.Same
BLDG PERMIT 0	# Full Baths 2	Phys. % Good 0%
Year Built 2019	# Half Baths 1	Funct. % Good 100%
Year Remodeled 0	# Addn Fixtures 0	Functional Code 9 None
Foundation 1 Concrete	# Fireplaces 0	1.Incomp 4.Delap 7.No Power
1.Concrete 4.Wood 7.	 <p>TRIO Software A Division of Harris Computer Systems</p>	2.O-Built 5.Bsmt 8.LongTerm
2.C Block 5.Slab 8.		3.Damage 6.Dbwd 9.None
3.Br/Stone 6.Piers 9.		Econ. % Good 100%
Basement 4 Full Basement		Economic Code None
1.1/4 Bmt 4.Full Bmt 7.	0.None 3.No Power 7.	Entrance Code 0
2.1/2 Bmt 5.None 8.	1.Location 4.Generate 8.	1.Interior 4.Vacant 7.Entered
3.3/4 Bmt 6. 9.None	2.Encroach 9.None 9.	2.Refusal 5.Estimate 8.No
Bsmt Gar # Cars 0		3.Informed 6.Reviewed 9.Land
Wet Basement 1 Dry Basement		Information Code 0
1.Dry 4. 7.		1.Owner 4.Agent 7.
2.Damp 5. 8.		2.Relative 5.Estimate 8.
3.Wet 6. 9.		3.Tenant 6.Other 9.

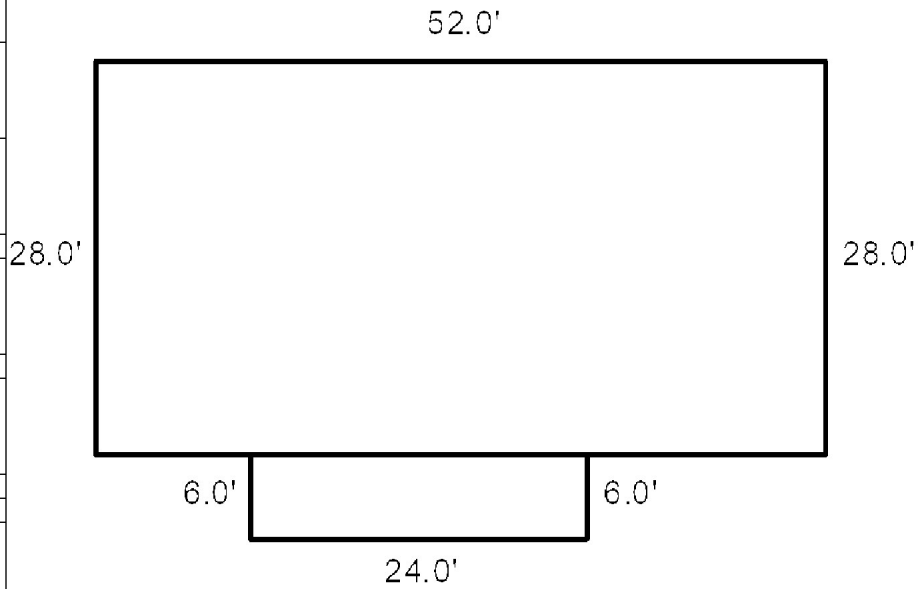

Date Inspected 4/07/2020

Additions, Outbuildings & Improvements

Type	Year	Units	Grade	Cond	Phys.	Funct.	Sound Value
68 Wood Deck	2019	144	3 100	4	0 %	100 %	
					%	%	
					%	%	
					%	%	
					%	%	
					%	%	
					%	%	
					%	%	
					%	%	
					%	%	
					%	%	
					%	%	



BRAY, CHRISTOPHER M
 BRAY, BECKY L
 998 MAIN ST
 BOWDOIN ME 04287

B2333P243

Inspection Witnessed By:

X	Date	Date Insp.
No./Date	Description	Date Insp.

Notes:

Bowdoin

Property Data			Assessment Record																																																																																																																																																																																	
Neighborhood 5 Map 5			Year	Land	Buildings	Exempt	Total																																																																																																																																																																													
Tree Growth Year 0			2009	60,680	185,880	10,000	236,560																																																																																																																																																																													
Farmland Yr 0			2010	60,680	185,880	10,000	236,560																																																																																																																																																																													
Open Space Yr 0			2011	60,680	185,880	10,000	236,560																																																																																																																																																																													
Zone/Land Use 11 Residential 1			2012	60,680	185,880	10,000	236,560																																																																																																																																																																													
Secondary Zone			2013	60,680	185,880	10,000	236,560																																																																																																																																																																													
Topography			2014	60,680	185,880	10,000	236,560																																																																																																																																																																													
1.Level 4.Below St 7.LevelBog			2015	60,680	185,880	10,000	236,560																																																																																																																																																																													
2.Rolling 5.Low 8.Conform			2016	60,680	185,880	15,000	231,560																																																																																																																																																																													
3.Above St 6.FZone 9.Non-Confor			2017	60,680	185,880	20,000	226,560																																																																																																																																																																													
Utilities			2018	60,680	185,880	20,000	226,560																																																																																																																																																																													
1.Public 4.Dr Well 7.Cesspool			2019	60,680	185,880	20,000	226,560																																																																																																																																																																													
2.Water 5.Dug Well 8.			2020	60,680	185,880	25,000	221,560																																																																																																																																																																													
3.Sewer 6.Septic 9.None			2021	60,680	185,880	25,000	221,560																																																																																																																																																																													
Street 1 Paved			2022	60,680	174,560	21,500	213,740																																																																																																																																																																													
1.Paved 4.Proposed 7.MHG			Land Data																																																																																																																																																																																	
2.Semi Imp 5.R/O/W 8.DIS																																																																																																																																																																																				
3.Gravel 6.MHP 9.None			Front Foot																																																																																																																																																																																	
TG PLAN YEAR 0																																																																																																																																																																																				
Tif District # 0			<table border="1"> <thead> <tr> <th>Type</th> <th colspan="2">Effective</th> <th colspan="2">Influence</th> <th rowspan="2">Influence Codes</th> </tr> <tr> <th></th> <th>Frontage</th> <th>Depth</th> <th>Factor</th> <th>Code</th> </tr> </thead> <tbody> <tr> <td>11.Road Frontage</td> <td></td> <td></td> <td>%</td> <td></td> <td>1.Unimproved</td> </tr> <tr> <td>12.Delta Triangle</td> <td></td> <td></td> <td>%</td> <td></td> <td>2.Excess Frtg</td> </tr> <tr> <td>13.Nabla Triangle</td> <td></td> <td></td> <td>%</td> <td></td> <td>3.Topography</td> </tr> <tr> <td>14.Rear Land</td> <td></td> <td></td> <td>%</td> <td></td> <td>4.Size/Shape</td> </tr> <tr> <td>15.Miscellaneous</td> <td></td> <td></td> <td>%</td> <td></td> <td>5.Access</td> </tr> <tr> <td></td> <td></td> <td></td> <td>%</td> <td></td> <td>6.Restriction</td> </tr> <tr> <td></td> <td></td> <td></td> <td>%</td> <td></td> <td>7.Open Space</td> </tr> <tr> <td></td> <td></td> <td></td> <td>%</td> <td></td> <td>8.View/Environ</td> </tr> <tr> <td></td> <td></td> <td></td> <td>%</td> <td></td> <td>9.Fract Share</td> </tr> <tr> <td></td> <td></td> <td></td> <td>%</td> <td></td> <td>Acres</td> </tr> <tr> <td></td> <td></td> <td></td> <td>%</td> <td></td> <td>30.Rear Land 3</td> </tr> <tr> <td></td> <td></td> <td></td> <td>%</td> <td></td> <td>31.Tillable</td> </tr> <tr> <td></td> <td></td> <td></td> <td>%</td> <td></td> <td>32.Pasture</td> </tr> <tr> <td></td> <td></td> <td></td> <td>%</td> <td></td> <td>33.Orchard</td> </tr> <tr> <td></td> <td></td> <td></td> <td>%</td> <td></td> <td>34.Softwood F&O</td> </tr> <tr> <td></td> <td></td> <td></td> <td>%</td> <td></td> <td>35.Mixed Wood F&O</td> </tr> <tr> <td></td> <td></td> <td></td> <td>%</td> <td></td> <td>36.Hardwood F&O</td> </tr> <tr> <td></td> <td></td> <td></td> <td>%</td> <td></td> <td>37.Softwood TG</td> </tr> <tr> <td></td> <td></td> <td></td> <td>%</td> <td></td> <td>38.Mixed Wood TG</td> </tr> <tr> <td></td> <td></td> <td></td> <td>%</td> <td></td> <td>39.Hardwood TG</td> </tr> <tr> <td></td> <td></td> <td></td> <td>%</td> <td></td> <td>40.Wasteland</td> </tr> <tr> <td></td> <td></td> <td></td> <td>%</td> <td></td> <td>41.Commercial</td> </tr> <tr> <td></td> <td></td> <td></td> <td>%</td> <td></td> <td>42.2nd Site</td> </tr> <tr> <td></td> <td></td> <td></td> <td>%</td> <td></td> <td>43.Post Rd</td> </tr> <tr> <td></td> <td></td> <td></td> <td>%</td> <td></td> <td>44.Lot Improvemen</td> </tr> <tr> <td></td> <td></td> <td></td> <td>%</td> <td></td> <td>45.Subdivision Lo</td> </tr> <tr> <td></td> <td></td> <td></td> <td>%</td> <td></td> <td>46.Golf Course</td> </tr> </tbody> </table>					Type	Effective		Influence		Influence Codes		Frontage	Depth	Factor	Code	11.Road Frontage			%		1.Unimproved	12.Delta Triangle			%		2.Excess Frtg	13.Nabla Triangle			%		3.Topography	14.Rear Land			%		4.Size/Shape	15.Miscellaneous			%		5.Access				%		6.Restriction				%		7.Open Space				%		8.View/Environ				%		9.Fract Share				%		Acres				%		30.Rear Land 3				%		31.Tillable				%		32.Pasture				%		33.Orchard				%		34.Softwood F&O				%		35.Mixed Wood F&O				%		36.Hardwood F&O				%		37.Softwood TG				%		38.Mixed Wood TG				%		39.Hardwood TG				%		40.Wasteland				%		41.Commercial				%		42.2nd Site				%		43.Post Rd				%		44.Lot Improvemen				%		45.Subdivision Lo				%		46.Golf Course
Type	Effective							Influence		Influence Codes																																																																																																																																																																										
	Frontage	Depth	Factor	Code																																																																																																																																																																																
11.Road Frontage			%		1.Unimproved																																																																																																																																																																															
12.Delta Triangle			%		2.Excess Frtg																																																																																																																																																																															
13.Nabla Triangle			%		3.Topography																																																																																																																																																																															
14.Rear Land			%		4.Size/Shape																																																																																																																																																																															
15.Miscellaneous			%		5.Access																																																																																																																																																																															
			%		6.Restriction																																																																																																																																																																															
			%		7.Open Space																																																																																																																																																																															
			%		8.View/Environ																																																																																																																																																																															
			%		9.Fract Share																																																																																																																																																																															
			%		Acres																																																																																																																																																																															
			%		30.Rear Land 3																																																																																																																																																																															
			%		31.Tillable																																																																																																																																																																															
			%		32.Pasture																																																																																																																																																																															
			%		33.Orchard																																																																																																																																																																															
			%		34.Softwood F&O																																																																																																																																																																															
			%		35.Mixed Wood F&O																																																																																																																																																																															
			%		36.Hardwood F&O																																																																																																																																																																															
			%		37.Softwood TG																																																																																																																																																																															
			%		38.Mixed Wood TG																																																																																																																																																																															
			%		39.Hardwood TG																																																																																																																																																																															
			%		40.Wasteland																																																																																																																																																																															
			%		41.Commercial																																																																																																																																																																															
			%		42.2nd Site																																																																																																																																																																															
			%		43.Post Rd																																																																																																																																																																															
			%		44.Lot Improvemen																																																																																																																																																																															
			%		45.Subdivision Lo																																																																																																																																																																															
			%		46.Golf Course																																																																																																																																																																															
Sale Data			Square Foot																																																																																																																																																																																	
Sale Date 12/29/2003																																																																																																																																																																																				
Price			<table border="1"> <thead> <tr> <th colspan="2">Fract. Acre</th> <th colspan="4">Acreage/Sites</th> </tr> </thead> <tbody> <tr> <td>21.Base 1 (Fract)</td> <td>24</td> <td>1.00</td> <td>100</td> <td>%</td> <td>0</td> </tr> <tr> <td>22.Base 2 (Fract)</td> <td>26</td> <td>2.00</td> <td>100</td> <td>%</td> <td>0</td> </tr> <tr> <td>23.Base 3</td> <td>28</td> <td>5.13</td> <td>100</td> <td>%</td> <td>0</td> </tr> <tr> <td>Acres</td> <td>44</td> <td>1.00</td> <td>100</td> <td>%</td> <td>0</td> </tr> <tr> <td>24.Base 1</td> <td></td> <td></td> <td></td> <td>%</td> <td></td> </tr> <tr> <td>25.Base 2</td> <td></td> <td></td> <td></td> <td>%</td> <td></td> </tr> <tr> <td>26.Frontage 1</td> <td></td> <td></td> <td></td> <td>%</td> <td></td> </tr> <tr> <td>27.Rear Land 4</td> <td></td> <td></td> <td></td> <td>%</td> <td></td> </tr> <tr> <td>28.Rear Land 1</td> <td></td> <td></td> <td></td> <td>%</td> <td></td> </tr> <tr> <td>29.Rear Land 2</td> <td></td> <td></td> <td></td> <td>%</td> <td></td> </tr> </tbody> </table>					Fract. Acre		Acreage/Sites				21.Base 1 (Fract)	24	1.00	100	%	0	22.Base 2 (Fract)	26	2.00	100	%	0	23.Base 3	28	5.13	100	%	0	Acres	44	1.00	100	%	0	24.Base 1				%		25.Base 2				%		26.Frontage 1				%		27.Rear Land 4				%		28.Rear Land 1				%		29.Rear Land 2				%																																																																																																												
Fract. Acre		Acreage/Sites																																																																																																																																																																																		
21.Base 1 (Fract)	24	1.00	100	%	0																																																																																																																																																																															
22.Base 2 (Fract)	26	2.00	100	%	0																																																																																																																																																																															
23.Base 3	28	5.13	100	%	0																																																																																																																																																																															
Acres	44	1.00	100	%	0																																																																																																																																																																															
24.Base 1				%																																																																																																																																																																																
25.Base 2				%																																																																																																																																																																																
26.Frontage 1				%																																																																																																																																																																																
27.Rear Land 4				%																																																																																																																																																																																
28.Rear Land 1				%																																																																																																																																																																																
29.Rear Land 2				%																																																																																																																																																																																
Sale Type			Fract. Acre																																																																																																																																																																																	
1.Land 4.Mobile 7.C/I L&B																																																																																																																																																																																				
2.L & B 5.Other 8.			Acres																																																																																																																																																																																	
3.Building 6.C/I Land 9.																																																																																																																																																																																				
Financing			<table border="1"> <thead> <tr> <th colspan="2">Verified</th> </tr> </thead> <tbody> <tr> <td>1.Buyer</td> <td>4.Agent</td> <td>7.Family</td> </tr> <tr> <td>2.Seller</td> <td>5.Pub Rec</td> <td>8.Other</td> </tr> <tr> <td>3.Lender</td> <td>6.MLS</td> <td>9.</td> </tr> </tbody> </table>					Verified		1.Buyer	4.Agent	7.Family	2.Seller	5.Pub Rec	8.Other	3.Lender	6.MLS	9.																																																																																																																																																																		
Verified																																																																																																																																																																																				
1.Buyer	4.Agent	7.Family																																																																																																																																																																																		
2.Seller	5.Pub Rec	8.Other																																																																																																																																																																																		
3.Lender	6.MLS	9.																																																																																																																																																																																		
1.Convent 4.Seller 7.			Acres																																																																																																																																																																																	
2.FHA/VA 5.Private 8.																																																																																																																																																																																				
3.Assumed 6.Cash 9.Unknown			<table border="1"> <thead> <tr> <th colspan="2">Total Acreage</th> </tr> </thead> <tbody> <tr> <td>8.13</td> <td></td> </tr> </tbody> </table>					Total Acreage		8.13																																																																																																																																																																										
Total Acreage																																																																																																																																																																																				
8.13																																																																																																																																																																																				
Validity 2 Related Parties			<table border="1"> <thead> <tr> <th colspan="2">Total Acreage</th> </tr> </thead> <tbody> <tr> <td>8.13</td> <td></td> </tr> </tbody> </table>					Total Acreage		8.13																																																																																																																																																																										
Total Acreage																																																																																																																																																																																				
8.13																																																																																																																																																																																				
1.Valid 4.Split 7.Renovate			<table border="1"> <thead> <tr> <th colspan="2">Total Acreage</th> </tr> </thead> <tbody> <tr> <td>8.13</td> <td></td> </tr> </tbody> </table>					Total Acreage		8.13																																																																																																																																																																										
Total Acreage																																																																																																																																																																																				
8.13																																																																																																																																																																																				
2.Related 5.Partial 8.Other			<table border="1"> <thead> <tr> <th colspan="2">Total Acreage</th> </tr> </thead> <tbody> <tr> <td>8.13</td> <td></td> </tr> </tbody> </table>					Total Acreage		8.13																																																																																																																																																																										
Total Acreage																																																																																																																																																																																				
8.13																																																																																																																																																																																				
3.Distress 6.Exempt 9.Short			<table border="1"> <thead> <tr> <th colspan="2">Total Acreage</th> </tr> </thead> <tbody> <tr> <td>8.13</td> <td></td> </tr> </tbody> </table>					Total Acreage		8.13																																																																																																																																																																										
Total Acreage																																																																																																																																																																																				
8.13																																																																																																																																																																																				
Verified			<table border="1"> <thead> <tr> <th colspan="2">Total Acreage</th> </tr> </thead> <tbody> <tr> <td>8.13</td> <td></td> </tr> </tbody> </table>					Total Acreage		8.13																																																																																																																																																																										
Total Acreage																																																																																																																																																																																				
8.13																																																																																																																																																																																				
1.Buyer 4.Agent 7.Family			<table border="1"> <thead> <tr> <th colspan="2">Total Acreage</th> </tr> </thead> <tbody> <tr> <td>8.13</td> <td></td> </tr> </tbody> </table>					Total Acreage		8.13																																																																																																																																																																										
Total Acreage																																																																																																																																																																																				
8.13																																																																																																																																																																																				
2.Seller 5.Pub Rec 8.Other			<table border="1"> <thead> <tr> <th colspan="2">Total Acreage</th> </tr> </thead> <tbody> <tr> <td>8.13</td> <td></td> </tr> </tbody> </table>					Total Acreage		8.13																																																																																																																																																																										
Total Acreage																																																																																																																																																																																				
8.13																																																																																																																																																																																				
3.Lender 6.MLS 9.			<table border="1"> <thead> <tr> <th colspan="2">Total Acreage</th> </tr> </thead> <tbody> <tr> <td>8.13</td> <td></td> </tr> </tbody> </table>					Total Acreage		8.13																																																																																																																																																																										
Total Acreage																																																																																																																																																																																				
8.13																																																																																																																																																																																				

Bowdoin

Map Lot 05-65-0

Account 548

Location 998 MAIN ST

Card 1 Of 1 7/19/2022

Building Style 2 Ranch	SF Bsmt Living 0	Layout 1 Typical
0.Not Code 4.Cape 8.Log	Fin Bsmt Grade 0 0	1.Typical 4. 7.
1.Conv. 5.Garrison 9.Other	OCCUPANCY 0	2.Inadeq 5. 8.
2.Ranch 6.Split 10.DW	Heat Type 100% 1 Hot Water BB	3.Poor 6. 9.
3.R Ranch 7.Contemp 11.Church	0.Not Code 4.Steam 8.Fi/Wall	Attic 9 None
Dwelling Units 1	1.HWBB 5.FWA 9.No Heat	1.1/4 Fin 4.Full Fin 7.
Other Units 0	2.HWCI 6.GravWA 11.	2.1/2 Fin 5.Fi/Stair 8.
Stories 1 One Story	3.H Pump 7.Electric 12.	3.3/4 Fin 6. 9.None
1.1 4.1.5 7.4	Cool Type 0% 9 None	Insulation 1 Full
2.2 5.1.75 8.20	1.Refrig 4.W&C Air 7.	1.Full 4.Minimal 7.
3.3 6.2.5 9.Yurt	2.Evapor 5. 8.	2.Heavy 5. 8.
Exterior Walls 2 Vinyl/Aluminum	3.H Pump 6. 9.None	3.Capped 6. 9.None
0.Not Code 4.Asbestos 8.Concrete	Kitchen Style 2 Typical	Unfinished % 0%
1.Wood 5.Stucco 9.Other	1.Modern 4.Obsolete 7.	Grade & Factor 3 Average 100%
2.Vin/Al 6.Brick 10.Board B	2.Typical 5. 8.	1.E Grade 4.B Grade 7.
3.Compos. 7.Stone 12.	3.Old Type 6. 9.None	2.D Grade 5.A Grade 8.
Roof Surface 1 Asphalt Shingles	Bath(s) Style 2 Typical Bath(s)	3.C Grade 6.AA Grade 9.Same
1.Asphalt 4.Composit 7.	1.Modern 4.Obsolete 7.	SQFT (Footprint) 1144
2.Slate 5.Wood 8.	2.Typical 5. 8.	Condition 3 Below Average
3.Metal 6.Other 9.	3.Old Type 6. 9.None	1.Poor 4.Avg 7.V G
SF Masonry Trim 0	# Rooms 7	2.Fair 5.Avg+ 8.Exc
SEPTIC DESIGN 0	# Bedrooms 3	3.Avg- 6.Good 9.Same
BLDG PERMIT 0	# Full Baths 1	Phys. % Good 0%
Year Built 1971	# Half Baths 0	Funct. % Good 100%
Year Remodeled 0	# Addn Fixtures 0	Functional Code 9 None
Foundation 1 Concrete	# Fireplaces 0	1.Incomp 4.Delap 7.No Power
1.Concrete 4.Wood 7.	 <p>TRIO Software A Division of Harris Computer Systems</p>	2.O-Built 5.Bsmt 8.LongTerm
2.C Block 5.Slab 8.		3.Damage 6.Dbwd 9.None
3.Br/Stone 6.Piers 9.		Econ. % Good 100%
Basement 4 Full Basement		Economic Code None
1.1/4 Bmt 4.Full Bmt 7.		0.None 3.No Power 7.
2.1/2 Bmt 5.None 8.		1.Location 4.Generate 8.
3.3/4 Bmt 6. 9.None		2.Encroach 9.None 9.
Bsmt Gar # Cars 0		Entrance Code 3 Information Only
Wet Basement 3 Wet Basement		1.Interior 4.Vacant 7.Entered
1.Dry 4. 7.		2.Refusal 5.Estimate 8.No
2.Damp 5. 8.	3.Informed 6.Reviewed 9.Land	
3.Wet 6. 9.	Information Code 1 Owner	
	1.Owner 4.Agent 7.	
	2.Relative 5.Estimate 8.	
	3.Tenant 6.Other 9.	

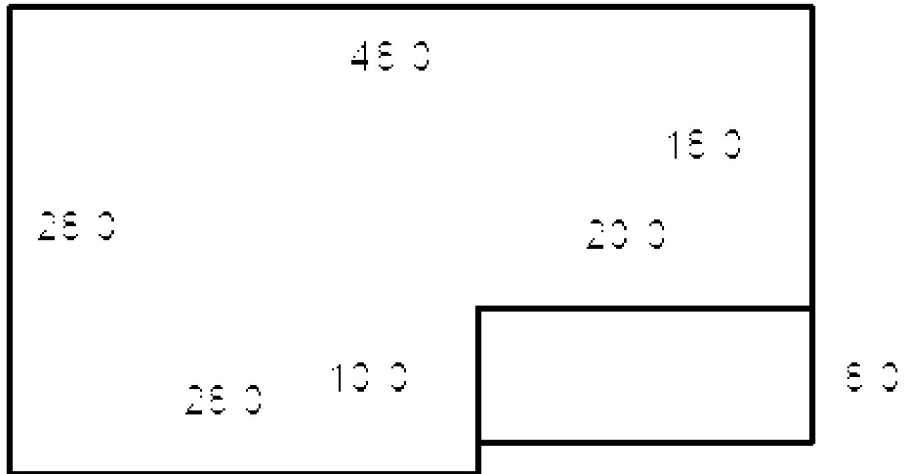

Date Inspected

Additions, Outbuildings & Improvements

Type	Year	Units	Grade	Cond	Phys.	Funct.	Sound Value
21 Open Frame	0	64	0 0	0	0 %	0 %	
30 Detached Garage	2004	1064	3 100	4	0 %	100 %	
68 Wood Deck	0	80	0 0	0	0 %	0 %	
1 One Story Frame	2007	1064	3 100	4	0 %	100 %	
68 Wood Deck	2007	180	3 100	4	0 %	100 %	
57 Living Space over	2004	1064	3 100	4	0 %	100 %	
					%	%	
					%	%	
					%	%	
					%	%	

- 1.One Story Fram
- 2.Two Story Fram
- 3.Three Story Fr
- 4.1 & 1/2 Story
- 5.1 & 3/4 Story
- 6.2 & 1/2 Story
- 21.Open Frame Por
- 22.Encl Frame Por
- 23.Attached Garag
- 24.Frame Shed
- 25.Frame Bay Wind
- 26.1SFr Overhang
- 27.Unfin Basement
- 28.Unfinished Att
- 29.Finished Attic

SWANHOLM, RICHARD C
SWANHOLM, DOREEN J
968 MAIN ST
BOWDOIN ME 04287

B1926P98

Inspection Witnessed By:

No./Date	Description	Date Insp.
X		

Notes:

Bowdoin

Property Data			Assessment Record				
Neighborhood 5 Map 5			Year	Land	Buildings	Exempt	Total
Tree Growth Year 0			2009	56,690	283,370	0	340,060
Farmland Yr 0			2010	56,690	282,480	10,000	329,170
Open Space Yr 0			2011	56,690	282,480	10,000	329,170
Zone/Land Use 11 Residential 1			2012	56,690	282,480	10,000	329,170
Secondary Zone			2013	56,690	282,480	10,000	329,170
Topography			2014	56,690	282,480	10,000	329,170
1.Level 4.Below St 7.LevelBog			2015	56,690	282,480	10,000	329,170
2.Rolling 5.Low 8.Conform			2016	56,690	282,480	15,000	324,170
3.Above St 6.FZone 9.Non-Confor			2017	56,690	282,480	20,000	319,170
Utilities			2018	56,690	282,480	20,000	319,170
1.Public 4.Dr Well 7.Cesspool			2019	56,690	282,480	20,000	319,170
2.Water 5.Dug Well 8.			2020	56,690	282,480	25,000	314,170
3.Sewer 6.Septic 9.None			2021	56,690	282,480	25,000	314,170
Street 1 Paved			2022	56,690	268,130	21,500	303,320
1.Paved 4.Proposed 7.MHG			Land Data				
2.Semi Imp 5.R/O/W 8.DIS							
3.Gravel 6.MHP 9.None			Front Foot				
TG PLAN YEAR 0							
Tif District # 0			Type				
Sale Data							
Sale Date 10/05/2001			Effective				
Price 29,500							
Sale Type 1 Land Only			Influence				
1.Land 4.Mobile 7.C/I L&B							
2.L & B 5.Other 8.			Influence Codes				
3.Building 6.C/I Land 9.							
Financing			Square Foot				
1.Convent 4.Seller 7.							
2.FHA/VA 5.Private 8.			Square Feet				
3.Assumed 6.Cash 9.Unknown							
Validity 1 Arms Length Sale			Acres/Sites				
1.Valid 4.Split 7.Renovate							
2.Related 5.Partial 8.Other			Acres				
3.Distress 6.Exempt 9.Short							
Verified			Fract. Acre				
1.Buyer 4.Agent 7.Family							
2.Seller 5.Pub Rec 8.Other			Acres				
3.Lender 6.MLS 9.							
			Total Acreage 10.42				

- 1.Unimproved
- 2.Excess Frtg
- 3.Topography
- 4.Size/Shape
- 5.Access
- 6.Restriction
- 7.Open Space
- 8.View/Environ
- 9.Fract Share
- Acres**
- 30.Rear Land 3
- 31.Tillable
- 32.Pasture
- 33.Orchard
- 34.Softwood F&O
- 35.Mixed Wood F&O
- 36.Hardwood F&O
- 37.Softwood TG
- 38.Mixed Wood TG
- 39.Hardwood TG
- 40.Wasteland
- 41.Commercial
- 42.2nd Site
- 43.Post Rd
- 44.Lot Improvemen
- 45.Subdivision Lo
- 46.Golf Course

Bowdoin

Map Lot 05-65-01

Account 549

Location 968 MAIN ST

Card 1 Of 1 7/19/2022

Building Style 7 Contemporary	SF Bsmt Living 0	Layout 1 Typical
0.Not Code 4.Cape 8.Log	Fin Bsmt Grade 0 0	1.Typical 4. 7.
1.Conv. 5.Garrison 9.Other	OCCUPANCY 0	2.Inadeq 5. 8.
2.Ranch 6.Split 10.DW	Heat Type 100% 1 Hot Water BB	3.Poor 6. 9.
3.R Ranch 7.Contemp 11.Church	0.Not Code 4.Steam 8.F/Wall	Attic 9 None
Dwelling Units 1	1.HWBB 5.FWA 9.No Heat	1.1/4 Fin 4.Full Fin 7.
Other Units 0	2.HWCI 6.GravWA 11.	2.1/2 Fin 5.F/Stair 8.
Stories 6 Two & 1/2 Story	3.H Pump 7.Electric 12.	3.3/4 Fin 6. 9.None
1.1 4.1.5 7.4	Cool Type 0% 9 None	Insulation 1 Full
2.2 5.1.75 8.20	1.Refrig 4.W&C Air 7.	1.Full 4.Minimal 7.
3.3 6.2.5 9.Yurt	2.Evapor 5. 8.	2.Heavy 5. 8.
Exterior Walls 2 Vinyl/Aluminum	3.H Pump 6. 9.None	3.Capped 6. 9.None
0.Not Code 4.Asbestos 8.Concrete	Kitchen Style 2 Typical	Unfinished % 0%
1.Wood 5.Stucco 9.Other	1.Modern 4.Obsolete 7.	Grade & Factor 4 Good 100%
2.Vin/Al 6.Brick 10.Board B	2.Typical 5. 8.	1.E Grade 4.B Grade 7.
3.Compos. 7.Stone 12.	3.Old Type 6. 9.None	2.D Grade 5.A Grade 8.
Roof Surface 1 Asphalt Shingles	Bath(s) Style 2 Typical Bath(s)	3.C Grade 6.AA Grade 9.Same
1.Asphalt 4.Composit 7.	1.Modern 4.Obsolete 7.	SQFT (Footprint) 1064
2.Slate 5.Wood 8.	2.Typical 5. 8.	Condition 4 Average
3.Metal 6.Other 9.	3.Old Type 6. 9.None	1.Poor 4.Avg 7.V G
SF Masonry Trim 0	# Rooms 10	2.Fair 5.Avg+ 8.Exc
SEPTIC DESIGN 0	# Bedrooms 3	3.Avg- 6.Good 9.Same
BLDG PERMIT 1708	# Full Baths 1	Phys. % Good 0%
Year Built 2002	# Half Baths 2	Funct. % Good 100%
Year Remodeled 0	# Addn Fixtures 0	Functional Code 9 None
Foundation 1 Concrete	# Fireplaces 1	1.Incomp 4.Delap 7.No Power
1.Concrete 4.Wood 7.		2.O-Built 5.Bsmt 8.LongTerm
2.C Block 5.Slab 8.		3.Damage 6.Dbwd 9.None
3.Br/Stone 6.Piers 9.		Econ. % Good 100%
Basement 4 Full Basement		Economic Code None
1.1/4 Bmt 4.Full Bmt 7.		0.None 3.No Power 7.
2.1/2 Bmt 5.None 8.		1.Location 4.Generate 8.
3.3/4 Bmt 6. 9.None		2.Encroach 9.None 9.
Bsmt Gar # Cars 0		Entrance Code 5 Estimated
Wet Basement 1 Dry Basement		1.Interior 4.Vacant 7.Entered
1.Dry 4. 7.		2.Refusal 5.Estimate 8.No
2.Damp 5. 8.		3.Informed 6.Reviewed 9.Land
3.Wet 6. 9.		Information Code 5 Estimate
		1.Owner 4.Agent 7.
		2.Relative 5.Estimate 8.
		3.Tenant 6.Other 9.



Date Inspected 4/30/2022

Additions, Outbuildings & Improvements

Type	Year	Units	Grade	Cond	Phys.	Funct.	Sound Value
68 Wood Deck	0	60	0 0	0	0 %	0 %	
11 One	2003	320	2 100	2	0 %	100 %	
23 Attached Garage	2008	624	3 100	3	0 %	100 %	
24 Frame Shed	2007	160	3 100	3	0 %	100 %	
70 Shed Roof	2007	80	3 100	3	0 %	100 %	
					%	%	
					%	%	
					%	%	
					%	%	
					%	%	

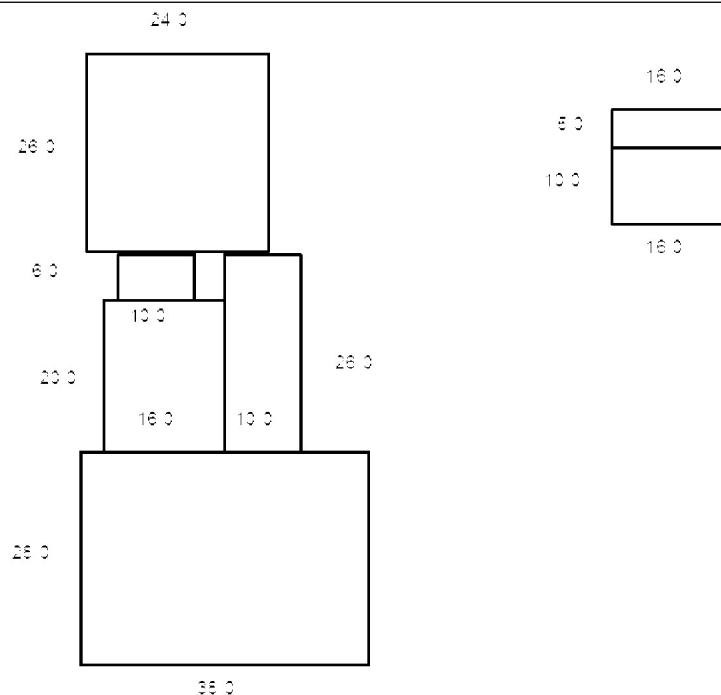

BOZEMAN, PETER CAREY
 MCMANUS, PAMELA S
 985 MAIN ST
 BOWDOIN ME 04287

B671P283 B3631P254

Previous Owner
 BOUCHARD, CAROLE J
 BOUCHARD, EDWARD P
 27A PROSPECT ST
 TOPSHAM ME 04086
 Sale Date: 9/24/2014

Inspection Witnessed By:

X	Date	Description	Date Insp.

Notes:

Bowdoin

Property Data			Assessment Record						
Neighborhood 5 Map 5			Year	Land	Buildings	Exempt	Total		
Tree Growth Year 0			2009	49,180	165,830	10,000	205,010		
Farmland Yr 0			2010	49,180	165,830	10,000	205,010		
Open Space Yr 0			2011	49,180	165,830	10,000	205,010		
Zone/Land Use 11 Residential 1			2012	49,180	165,830	10,000	205,010		
Secondary Zone			2013	49,180	165,830	10,000	205,010		
Topography			2014	49,180	165,830	10,000	205,010		
1.Level 4.Below St 7.LevelBog			2015	49,180	165,830	0	215,010		
2.Rolling 5.Low 8.Conform			2016	49,180	165,830	0	215,010		
3.Above St 6.FZone 9.Non-Confor			2017	49,180	165,830	0	215,010		
Utilities			2018	49,180	165,830	0	215,010		
1.Public 4.Dr Well 7.Cesspool			2019	49,180	165,830	0	215,010		
2.Water 5.Dug Well 8.			2020	49,180	165,830	0	215,010		
3.Sewer 6.Septic 9.None			2021	49,180	165,830	0	215,010		
Street 1 Paved			2022	49,180	157,900	0	207,080		
1.Paved 4.Proposed 7.MHG			Land Data						
2.Semi Imp 5.R/O/W 8.DIS			Front Foot	Type	Effective		Influence		Influence Codes
3.Gravel 6.MHP 9.None					Frontage	Depth	Factor	Code	
TG PLAN YEAR 0			11.Road Frontage					1.Unimproved	
Tif District # 0			12.Delta Triangle					2.Excess Frtg	
Sale Data			13.Nabla Triangle					3.Topography	
			14.Rear Land					4.Size/Shape	
Sale Date 9/24/2014			15.Miscellaneous					5.Access	
Price 200,900								6.Restriction	
Sale Type 2 Land & Buildings								7.Open Space	
1.Land 4.Mobile 7.C/I L&B			Square Foot		Square Feet			8.View/Environ	
2.L & B 5.Other 8.			16.Regular Lot					9.Fract Share	
3.Building 6.C/I Land 9.			17.Secondary Lot					Acres	
Financing 9 Unknown			18.Hydro Facility					30.Rear Land 3	
1.Convent 4.Seller 7.			19.Improvements					31.Tillable	
2.FHA/VA 5.Private 8.			20.Base 3 (Fract)					32.Pasture	
3.Assumed 6.Cash 9.Unknown								33.Orchard	
Validity 1 Arms Length Sale			Fract. Acre	Acreege/Sites				34.Softwood F&O	
1.Valid 4.Split 7.Renovate			21.Base 1 (Fract)	24	1.00	100	%	0	
2.Related 5.Partial 8.Other			22.Base 2 (Fract)	28	1.20	100	%	0	
3.Distress 6.Exempt 9.Short			23.Base 3	44	1.00	100	%	0	
Verified 5 Public Record			Acres	52	150.00	100	%	0	
1.Buyer 4.Agent 7.Family			24.Base 1						
2.Seller 5.Pub Rec 8.Other			25.Base 2						
3.Lender 6.MLS 9.			26.Frontage 1						
			27.Rear Land 4						
			28.Rear Land 1						
			29.Rear Land 2						
			Total Acreage		2.20				
								44.Lot Improvemen	
								45.Subdivision Lo	
								46.Golf Course	

Bowdoin

Map Lot 05-67-0

Account 551

Location 985 MAIN ST

Card 1 Of 1 7/19/2022

Building Style 7 Contemporary	SF Bsmt Living 0	Layout 1 Typical
0.Not Code 4.Cape 8.Log	Fin Bsmt Grade 0 0	1.Typical 4. 7.
1.Conv. 5.Garrison 9.Other	OCCUPANCY 0	2.Inadeq 5. 8.
2.Ranch 6.Split 10.DW	Heat Type 100% 1 Hot Water BB	3.Poor 6. 9.
3.R Ranch 7.Contemp 11.Church	0.Not Code 4.Steam 8.FI/Wall	Attic 9 None
Dwelling Units 1	1.HWBB 5.FWA 9.No Heat	1.1/4 Fin 4.Full Fin 7.
Other Units 0	2.HWCI 6.GravWA 11.	2.1/2 Fin 5.FI/Stair 8.
Stories 2 Two Story	3.H Pump 7.Electric 12.	3.3/4 Fin 6. 9.None
1.1 4.1.5 7.4	Cool Type 0% 9 None	Insulation 1 Full
2.2 5.1.75 8.20	1.Refrig 4.W&C Air 7.	1.Full 4.Minimal 7.
3.3 6.2.5 9.Yurt	2.Evapor 5. 8.	2.Heavy 5. 8.
Exterior Walls 1 Wood Siding	3.H Pump 6. 9.None	3.Capped 6. 9.None
0.Not Code 4.Asbestos 8.Concrete	Kitchen Style 2 Typical	Unfinished % 0%
1.Wood 5.Stucco 9.Other	1.Modern 4.Obsolete 7.	Grade & Factor 3 Average 100%
2.Vin/Al 6.Brick 10.Board B	2.Typical 5. 8.	1.E Grade 4.B Grade 7.
3.Compos. 7.Stone 12.	3.Old Type 6. 9.None	2.D Grade 5.A Grade 8.
Roof Surface 1 Asphalt Shingles	Bath(s) Style 2 Typical Bath(s)	3.C Grade 6.AA Grade 9.Same
1.Asphalt 4.Composit 7.	1.Modern 4.Obsolete 7.	SQFT (Footprint) 528
2.Slate 5.Wood 8.	2.Typical 5. 8.	Condition 4 Average
3.Metal 6.Other 9.	3.Old Type 6. 9.None	1.Poor 4.Avg 7.V G
SF Masonry Trim 0	# Rooms 7	2.Fair 5.Avg+ 8.Exc
SEPTIC DESIGN 0	# Bedrooms 2	3.Avg- 6.Good 9.Same
BLDG PERMIT 0	# Full Baths 1	Phys. % Good 0%
Year Built 1984	# Half Baths 1	Funct. % Good 100%
Year Remodeled 0	# Addn Fixtures 0	Functional Code 9 None
Foundation 1 Concrete	# Fireplaces 0	1.Incomp 4.Delap 7.No Power
1.Concrete 4.Wood 7.	 <p>TRIO Software A Division of Harris Computer Systems</p>	2.O-Built 5.Bsmt 8.LongTerm
2.C Block 5.Slab 8.		3.Damage 6.Dbwd 9.None
3.Br/Stone 6.Piers 9.		Econ. % Good 100%
Basement 4 Full Basement		Economic Code None
1.1/4 Bmt 4.Full Bmt 7.		0.None 3.No Power 7.
2.1/2 Bmt 5.None 8.		1.Location 4.Generate 8.
3.3/4 Bmt 6. 9.None		2.Encroach 9.None 9.
Bsmt Gar # Cars 0		Entrance Code 3 Information Only
Wet Basement 1 Dry Basement		1.Interior 4.Vacant 7.Entered
1.Dry 4. 7.		2.Refusal 5.Estimate 8.No
2.Damp 5. 8.	3.Informed 6.Reviewed 9.Land	
3.Wet 6. 9.	Information Code 1 Owner	
	1.Owner 4.Agent 7.	
	2.Relative 5.Estimate 8.	
	3.Tenant 6.Other 9.	

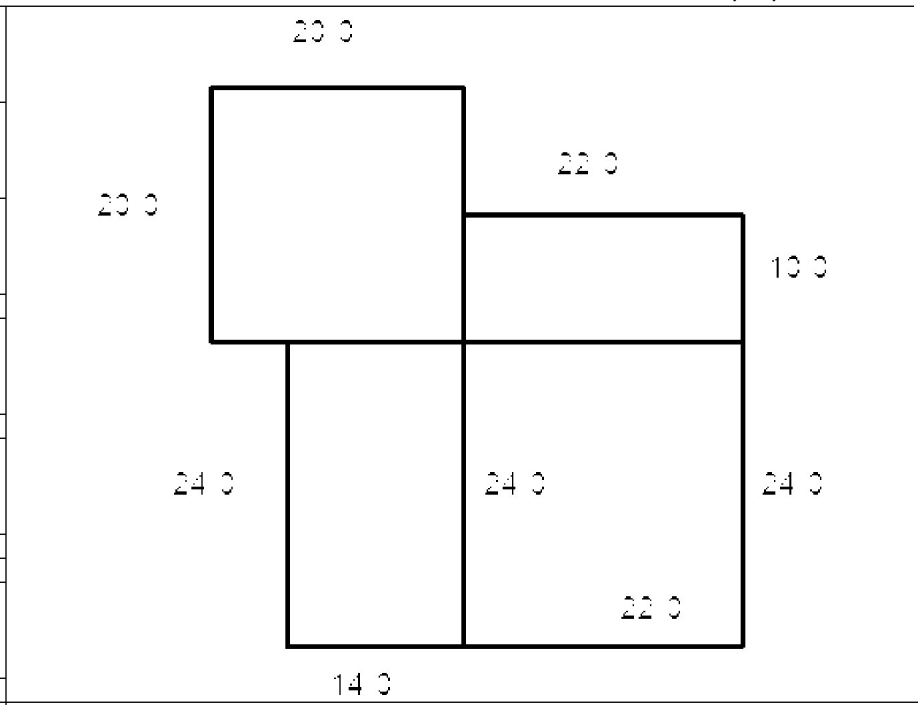

Date Inspected

Additions, Outbuildings & Improvements

Type	Year	Units	Grade	Cond	Phys.	Funct.	Sound Value
1 One Story Frame	0	336	0 0	0	0 %	0 %	
68 Wood Deck	0	44	0 0	0	0 %	0 %	
68 Wood Deck	0	176	0 0	0	0 %	0 %	
68 Wood Deck	1985	400	3 100	4	0 %	100 %	
63 Swimming Pool	1988	480	3 100	4	0 %	100 %	
30 Detached Garage	1996	1920	3 100	4	0 %	100 %	
					%	%	
					%	%	
					%	%	
					%	%	
					%	%	

- 1.One Story Fram
- 2.Two Story Fram
- 3.Three Story Fr
- 4.1 & 1/2 Story
- 5.1 & 3/4 Story
- 6.2 & 1/2 Story
- 21.Open Frame Por
- 22.Encl Frame Por
- 23.Attached Garag
- 24.Frame Shed
- 25.Frame Bay Wind
- 26.1SFr Overhang
- 27.Unfin Basement
- 28.Unfinished Att
- 29.Finished Attic

SMITH, ALDRED B
971 MAIN ST
BOWDOIN ME 04287

B1098P344

Inspection Witnessed By:

No./Date	Description	Date Insp.
X		

Notes:

Bowdoin

Property Data			Assessment Record				
Neighborhood 5 Map 5			Year	Land	Buildings	Exempt	Total
Tree Growth Year 0			2009	92,740	103,000	10,000	185,740
Farmland Yr 0			2010	92,740	103,000	10,000	185,740
Open Space Yr 0			2011	92,740	130,660	10,000	213,400
Zone/Land Use 11 Residential 1			2012	60,610	86,950	10,000	137,560
Secondary Zone			2013	60,610	86,950	10,000	137,560
Topography			2014	60,610	86,950	10,000	137,560
1.Level 4.Below St 7.LevelBog			2015	60,610	86,950	10,000	137,560
2.Rolling 5.Low 8.Conform			2016	60,610	86,950	15,000	132,560
3.Above St 6.FZone 9.Non-Confor			2017	60,610	86,950	26,000	121,560
Utilities			2018	60,610	86,950	26,000	121,560
1.Public 4.Dr Well 7.Cesspool			2019	60,610	86,950	26,000	121,560
2.Water 5.Dug Well 8.			2020	60,610	86,950	31,000	116,560
3.Sewer 6.Septic 9.None			2021	60,610	86,950	31,000	116,560
Street 1 Paved			2022	60,610	82,880	26,660	116,830
1.Paved 4.Proposed 7.MHG			Land Data				
2.Semi Imp 5.R/O/W 8.DIS							
3.Gravel 6.MHP 9.None			Front Foot				
TG PLAN YEAR 0							
Tif District # 0			Type				
Sale Data							
Sale Date			Effective				
Price							
Sale Type			Influence				
1.Land 4.Mobile 7.C/I L&B							
2.L & B 5.Other 8.			Influence Codes				
3.Building 6.C/I Land 9.							
Financing			Square Foot				
1.Convent 4.Seller 7.							
2.FHA/VA 5.Private 8.			Square Feet				
3.Assumed 6.Cash 9.Unknown							
Validity			Fract. Acre				
1.Valid 4.Split 7.Renovate							
2.Related 5.Partial 8.Other			Acres				
3.Distress 6.Exempt 9.Short							
Verified			Acres				
1.Buyer 4.Agent 7.Family							
2.Seller 5.Pub Rec 8.Other			Acres				
3.Lender 6.MLS 9.							

- 1.Unimproved
- 2.Excess Frtg
- 3.Topography
- 4.Size/Shape
- 5.Access
- 6.Restriction
- 7.Open Space
- 8.View/Environ
- 9.Fract Share
- Acres**
- 30.Rear Land 3
- 31.Tillable
- 32.Pasture
- 33.Orchard
- 34.Softwood F&O
- 35.Mixed Wood F&O
- 36.Hardwood F&O
- 37.Softwood TG
- 38.Mixed Wood TG
- 39.Hardwood TG
- 40.Wasteland
- 41.Commercial
- 42.2nd Site
- 43.Post Rd
- 44.Lot Improvemen
- 45.Subdivision Lo
- 46.Golf Course

Total Acreage 9.22

Bowdoin

Map Lot 05-68-0

Account 552

Location 971 MAIN ST

Card 1 Of 1 7/19/2022

Building Style 0 Not Coded	SF Bsmt Living 0	Layout 0
0.Not Code 4.Cape 8.Log	Fin Bsmt Grade 0 0	1.Typical 4. 7.
1.Conv. 5.Garrison 9.Other	OCCUPANCY 0	2.Inadeq 5. 8.
2.Ranch 6.Split 10.DW	Heat Type 100% 0 Not Coded	3.Poor 6. 9.
3.R Ranch 7.Contemp 11.Church	0.Not Code 4.Steam 8.FI/Wall	Attic 0
Dwelling Units 0	1.HWBB 5.FWA 9.No Heat	1.1/4 Fin 4.Full Fin 7.
Other Units 0	2.HWCI 6.GravWA 11.	2.1/2 Fin 5.FI/Stair 8.
Stories 0	3.H Pump 7.Electric 12.	3.3/4 Fin 6. 9.None
1.1 4.1.5 7.4	Cool Type 0% 9 None	Insulation 0
2.2 5.1.75 8.20	1.Refrig 4.W&C Air 7.	1.Full 4.Minimal 7.
3.3 6.2.5 9.Yurt	2.Evapor 5. 8.	2.Heavy 5. 8.
Exterior Walls 0 Not Coded	3.H Pump 6. 9.None	3.Capped 6. 9.None
0.Not Code 4.Asbestos 8.Concrete	Kitchen Style 0	Unfinished % 0%
1.Wood 5.Stucco 9.Other	1.Modern 4.Obsolete 7.	Grade & Factor 0 0%
2.Vin/Al 6.Brick 10.Board B	2.Typical 5. 8.	1.E Grade 4.B Grade 7.
3.Compos. 7.Stone 12.	3.Old Type 6. 9.None	2.D Grade 5.A Grade 8.
Roof Surface 0	Bath(s) Style 0	3.C Grade 6.AA Grade 9.Same
1.Asphalt 4.Composit 7.	1.Modern 4.Obsolete 7.	SQFT (Footprint) 0
2.Slate 5.Wood 8.	2.Typical 5. 8.	Condition 0
3.Metal 6.Other 9.	3.Old Type 6. 9.None	1.Poor 4.Avg 7.V G
SF Masonry Trim 0	# Rooms 0	2.Fair 5.Avg+ 8.Exc
SEPTIC DESIGN 0	# Bedrooms 0	3.Avg- 6.Good 9.Same
BLDG PERMIT 0	# Full Baths 0	Phys. % Good 0%
Year Built 0	# Half Baths 0	Funct. % Good 100%
Year Remodeled 0	# Addn Fixtures 0	Functional Code 9 None
Foundation 0	# Fireplaces 0	1.Incomp 4.Delap 7.No Power
1.Concrete 4.Wood 7.		2.O-Built 5.Bsmt 8.LongTerm
2.C Block 5.Slab 8.		3.Damage 6.Dbwd 9.None
3.Br/Stone 6.Piers 9.		Econ. % Good 100%
Basement 0		Economic Code None
1.1/4 Bmt 4.Full Bmt 7.		0.None 3.No Power 7.
2.1/2 Bmt 5.None 8.		1.Location 4.Generate 8.
3.3/4 Bmt 6. 9.None		2.Encroach 9.None 9.
Bsmt Gar # Cars 0		Entrance Code 3 Information Only
Wet Basement 0		1.Interior 4.Vacant 7.Entered
1.Dry 4. 7.		2.Refusal 5.Estimate 8.No
2.Damp 5. 8.		3.Informed 6.Reviewed 9.Land
3.Wet 6. 9.		Information Code 6 Other
		1.Owner 4.Agent 7.
		2.Relative 5.Estimate 8.
		3.Tenant 6.Other 9.

Date Inspected 3/22/2012

Additions, Outbuildings & Improvements

Type	Year	Units	Grade	Cond	Phys.	Funct.	Sound Value
997 12Mobile Home	1963	12x44	2 100	4	0 %	100 %	
1 One Story Frame	1988	294	2 100	4	0 %	100 %	
30 Detached Garage	1988	832	3 100	4	0 %	100 %	
66 Pole Barn	1993	780	2 100	3	0 %	100 %	
1 One Story Frame	1993	273	2 100	3	0 %	100 %	
70 Shed Roof	1993	384	2 100	3	0 %	100 %	
1 One Story Frame	2004	480	2 100	4	0 %	100 %	
68 Wood Deck	1988	189	3 100	4	0 %	100 %	
					%	%	
					%	%	

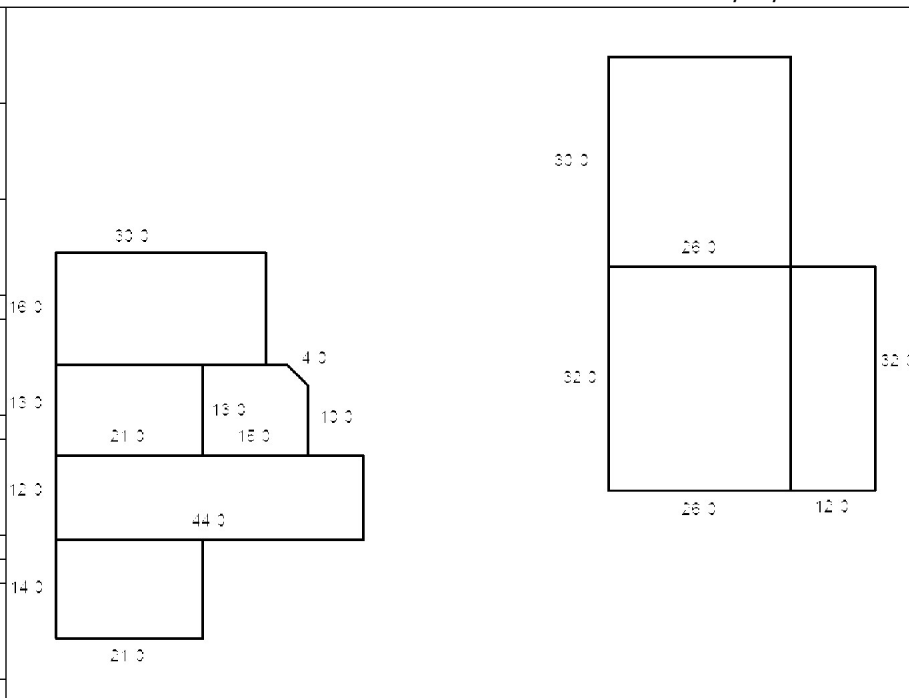

NOURI, BRIANNA E
NOURI, ZACHERY C.
22 KINFOLK LN
BOWDOIN ME 04287

B3298P193 B2016RP801 B2022RP1465

Previous Owner
POTTER, BRIANNA E
NOURI, ZACHERY C
22 KINFOLK LN
BOWDOIN ME 04287
Sale Date: 3/03/2021

Previous Owner
BARD, KAMI
22 KINFOLK LN

BOWDOIN ME 04287
Sale Date: 1/26/2016

Previous Owner
SMITH, ALDRED
SMITH, PAMELA
971 MAIN ST
BOWDOIN ME 04287
Sale Date: 6/23/2011

Inspection Witnessed By:

X	Date
No./Date	Description
	Date Insp.

Notes:

Bowdoin

Property Data			Assessment Record						
Neighborhood 5 Map 5			Year	Land	Buildings	Exempt	Total		
Tree Growth Year 0			2009	45,430	213,930	0	259,360		
Farmland Yr 0			2010	45,430	213,930	0	259,360		
Open Space Yr 0			2011	45,430	213,930	0	259,360		
Zone/Land Use 11 Residential 1			2012	45,430	212,260	0	257,690		
Secondary Zone			2013	45,430	212,260	0	257,690		
Topography			2014	45,430	212,260	0	257,690		
1.Level 4.Below St 7.LevelBog			2015	45,430	212,260	10,000	247,690		
2.Rolling 5.Low 8.Conform			2016	45,430	212,260	15,000	242,690		
3.Above St 6.FZone 9.Non-Confor			2017	45,430	212,260	20,000	237,690		
Utilities			2018	45,430	212,260	20,000	237,690		
1.Public 4.Dr Well 7.Cesspool			2019	45,430	232,720	20,000	258,150		
2.Water 5.Dug Well 8.			2020	45,430	232,720	25,000	253,150		
3.Sewer 6.Septic 9.None			2021	45,430	232,720	25,000	253,150		
Street			2022	45,430	235,050	21,500	258,980		
1.Paved 4.Proposed 7.MHG			Land Data						
2.Semi Imp 5.R/O/W 8.DIS									
3.Gravel 6.MHP 9.None			Front Foot	Type	Effective		Influence		Influence Codes
TG PLAN YEAR 0			11.Road Frontage		Frontage	Depth	Factor	Code	
Tif District # 0			12.Delta Triangle				%		1.Unimproved
Sale Data			13.Nabla Triangle				%		2.Excess Frtg
Sale Date 3/03/2021			14.Rear Land				%		3.Topography
Price			15.Miscellaneous				%		4.Size/Shape
Sale Type 2 Land & Buildings							%		5.Access
1.Land 4.Mobile 7.C/I L&B							%		6.Restriction
2.L & B 5.Other 8.			Square Foot	Square Feet					7.Open Space
3.Building 6.C/I Land 9.			16.Regular Lot				%		8.View/Environ
Financing 9 Unknown			17.Secondary Lot				%		9.Fract Share
1.Convent 4.Seller 7.			18.Hydro Facility				%		Acres
2.FHA/VA 5.Private 8.			19.Improvements				%		30.Rear Land 3
3.Assumed 6.Cash 9.Unknown			20.Base 3 (Fract)				%		31.Tillable
Validity 2 Related Parties							%		32.Pasture
1.Valid 4.Split 7.Renovate			Fract. Acre	Acres/Sites					33.Orchard
2.Related 5.Partial 8.Other			21.Base 1 (Fract)	25	1.00	100	%	0	34.Softwood F&O
3.Distress 6.Exempt 9.Short			22.Base 2 (Fract)	28	1.38	100	%	0	35.Mixed Wood F&O
Verified 5 Public Record			23.Base 3	44	1.00	100	%	0	36.Hardwood F&O
1.Buyer 4.Agent 7.Family			Acres				%		37.Softwood TG
2.Seller 5.Pub Rec 8.Other			24.Base 1				%		38.Mixed Wood TG
3.Lender 6.MLS 9.			25.Base 2				%		39.Hardwood TG
			26.Frontage 1				%		40.Wasteland
			27.Rear Land 4				%		41.Commercial
			28.Rear Land 1				%		42.2nd Site
			29.Rear Land 2				%		43.Post Rd
			Total Acreage		2.38				44.Lot Improvemen
									45.Subdivision Lo
									46.Golf Course

Bowdoin

Map Lot 05-68-01

Account 1804

Location 22 KINFOLK LN

Card 1 Of 1 7/19/2022

Building Style 1 Conventional	SF Bsmt Living 0	Layout 1 Typical
0.Not Code 4.Cape 8.Log	Fin Bsmt Grade 0 0	1.Typical 4. 7.
1.Conv. 5.Garrison 9.Other	OCCUPANCY 0	2.Inadeq 5. 8.
2.Ranch 6.Split 10.DW	Heat Type 100% 1 Hot Water BB	3.Poor 6. 9.
3.R Ranch 7.Contemp 11.Church	0.Not Code 4.Steam 8.F/Wall	Attic 0
Dwelling Units 1	1.HWBB 5.FWA 9.No Heat	1.1/4 Fin 4.Full Fin 7.
Other Units 0	2.HWCI 6.GravWA 11.	2.1/2 Fin 5.F/Stair 8.
Stories 5 One & 3/4 Story	3.H Pump 7.Electric 12.	3.3/4 Fin 6. 9.None
1.1 4.1.5 7.4	Cool Type 0% 9 None	Insulation 0
2.2 5.1.75 8.20	1.Refrig 4.W&C Air 7.	1.Full 4.Minimal 7.
3.3 6.2.5 9.Yurt	2.Evapor 5. 8.	2.Heavy 5. 8.
Exterior Walls 2 Vinyl/Aluminum	3.H Pump 6. 9.None	3.Capped 6. 9.None
0.Not Code 4.Asbestos 8.Concrete	Kitchen Style 2 Typical	Unfinished % 0%
1.Wood 5.Stucco 9.Other	1.Modern 4.Obsolete 7.	Grade & Factor 3 Average 100%
2.Vin/Al 6.Brick 10.Board B	2.Typical 5. 8.	1.E Grade 4.B Grade 7.
3.Compos. 7.Stone 12.	3.Old Type 6. 9.None	2.D Grade 5.A Grade 8.
Roof Surface 1 Asphalt Shingles	Bath(s) Style 2 Typical Bath(s)	3.C Grade 6.AA Grade 9.Same
1.Asphalt 4.Composit 7.	1.Modern 4.Obsolete 7.	SQFT (Footprint) 1272
2.Slate 5.Wood 8.	2.Typical 5. 8.	Condition 4 Average
3.Metal 6.Other 9.	3.Old Type 6. 9.None	1.Poor 4.Avg 7.V G
SF Masonry Trim 0	# Rooms 0	2.Fair 5.Avg+ 8.Exc
SEPTIC DESIGN 0	# Bedrooms 3	3.Avg- 6.Good 9.Same
BLDG PERMIT 0	# Full Baths 2	Phys. % Good 0%
Year Built 2007	# Half Baths 1	Funct. % Good 100%
Year Remodeled 0	# Addn Fixtures 0	Functional Code 9 None
Foundation 1 Concrete	# Fireplaces 0	1.Incomp 4.Delap 7.No Power
1.Concrete 4.Wood 7.	 <p>TRIO Software A Division of Harris Computer Systems</p>	2.O-Built 5.Bsmt 8.LongTerm
2.C Block 5.Slab 8.		3.Damage 6.Dbwd 9.None
3.Br/Stone 6.Piers 9.		Econ. % Good 100%
Basement 4 Full Basement		Economic Code None
1.1/4 Bmt 4.Full Bmt 7.		0.None 3.No Power 7.
2.1/2 Bmt 5.None 8.		1.Location 4.Generate 8.
3.3/4 Bmt 6. 9.None		2.Encroach 9.None 9.
Bsmt Gar # Cars 0		Entrance Code 5 Estimated
Wet Basement 0		1.Interior 4.Vacant 7.Entered
1.Dry 4. 7.		2.Refusal 5.Estimate 8.No
2.Damp 5. 8.	3.Informed 6.Reviewed 9.Land	
3.Wet 6. 9.	Information Code 6 Other	
	1.Owner 4.Agent 7.	
	2.Relative 5.Estimate 8.	
	3.Tenant 6.Other 9.	

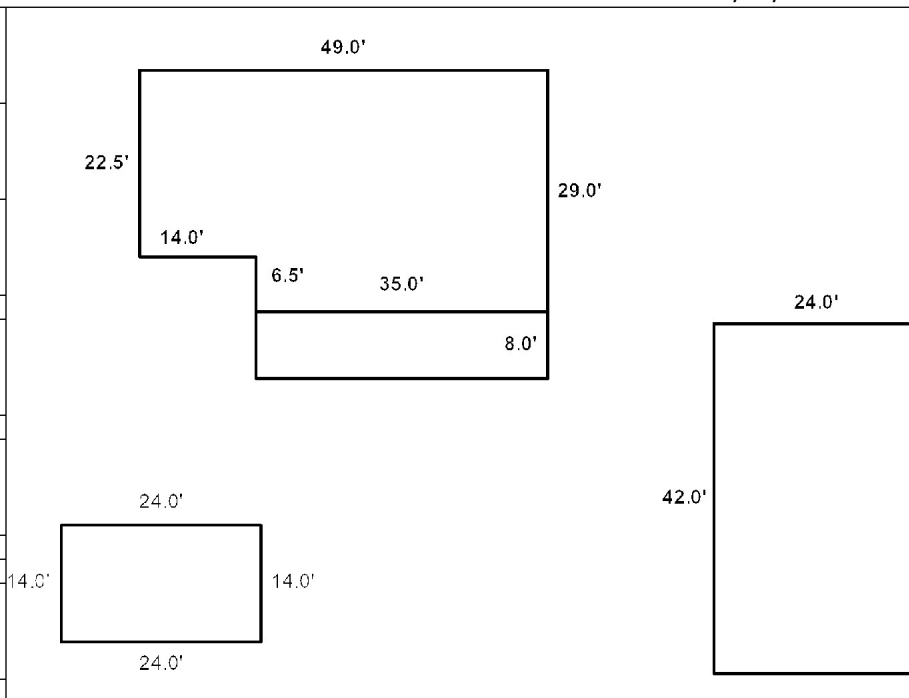

Date Inspected 4/05/2022

Additions, Outbuildings & Improvements

Type	Year	Units	Grade	Cond	Phys.	Funct.	Sound Value
21 Open Frame	2007	280	3 100	3	0 %	100 %	
24 Frame Shed	1990	724	3 100	3	0 %	100 %	
30 Detached Garage	2019	1008	3 100	4	0 %	100 %	
24 Frame Shed	2021	336	3 100	3	0 %	100 %	
					%	%	
					%	%	
					%	%	
					%	%	
					%	%	
					%	%	
					%	%	
					%	%	

- 1.One Story Fram
- 2.Two Story Fram
- 3.Three Story Fr
- 4.1 & 1/2 Story
- 5.1 & 3/4 Story
- 6.2 & 1/2 Story
- 21.Open Frame Por
- 22.Encl Frame Por
- 23.Attached Garag
- 24.Frame Shed
- 25.Frame Bay Wind
- 26.1SFr Overhang
- 27.Unfin Basement
- 28.Unfinished Att
- 29.Finished Attic

SMITH, ALDRED
971 MAIN ST
BOWDOIN ME 04287

B1098P345

Inspection Witnessed By:

No./Date	Description	Date Insp.
X		

Notes:

Bowdoin

Property Data			Assessment Record						
Neighborhood 5 Map 5			Year	Land	Buildings	Exempt	Total		
Tree Growth Year 0			2009	48,900	14,350	0	63,250		
Farmland Yr 0			2010	48,900	14,350	0	63,250		
Open Space Yr 0			2011	48,900	14,350	0	63,250		
Zone/Land Use 11 Residential 1			2012	48,900	14,350	0	63,250		
Secondary Zone			2013	48,900	14,350	0	63,250		
Topography			2014	48,900	14,350	0	63,250		
1.Level 4.Below St 7.LevelBog			2015	48,900	14,350	0	63,250		
2.Rolling 5.Low 8.Conform			2016	48,900	14,350	0	63,250		
3.Above St 6.FZone 9.Non-Confor			2017	48,900	14,350	0	63,250		
Utilities			2018	48,900	14,350	0	63,250		
1.Public 4.Dr Well 7.Cesspool			2019	48,900	14,350	0	63,250		
2.Water 5.Dug Well 8.			2020	48,900	14,350	0	63,250		
3.Sewer 6.Septic 9.None			2021	48,900	14,350	0	63,250		
Street 1 Paved			2022	48,900	14,100	0	63,000		
1.Paved 4.Proposed 7.MHG			Land Data						
2.Semi Imp 5.R/O/W 8.DIS									
3.Gravel 6.MHP 9.None			Front Foot	Type	Effective		Influence		Influence Codes
TG PLAN YEAR 0			11.Road Frontage		Frontage	Depth	Factor	Code	
Tif District # 0			12.Delta Triangle				%		1.Unimproved
Sale Data			13.Nabla Triangle				%		2.Excess Frtg
Sale Date 1/06/1992			14.Rear Land				%		3.Topography
Price			15.Miscellaneous				%		4.Size/Shape
Sale Type 2 Land & Buildings							%		5.Access
1.Land 4.Mobile 7.C/I L&B			Square Foot	Square Feet					6.Restriction
2.L & B 5.Other 8.			16.Regular Lot				%		7.Open Space
3.Building 6.C/I Land 9.			17.Secondary Lot				%		8.View/Environ
Financing 9 Unknown			18.Hydro Facility				%		9.Fract Share
1.Convent 4.Seller 7.			19.Improvements				%		Acres
2.FHA/VA 5.Private 8.			20.Base 3 (Fract)				%		30.Rear Land 3
3.Assumed 6.Cash 9.Unknown							%		31.Tillable
Validity 2 Related Parties			Fract. Acre	Acres/Sites					32.Pasture
1.Valid 4.Split 7.Renovate			21.Base 1 (Fract)	24	1.00	100	%	0	33.Orchard
2.Related 5.Partial 8.Other			22.Base 2 (Fract)	28	1.00	100	%	0	34.Softwood F&O
3.Distress 6.Exempt 9.Short			23.Base 3	44	1.00	100	%	0	35.Mixed Wood F&O
Verified 5 Public Record			Acres	52	308.07	100	%	0	36.Hardwood F&O
1.Buyer 4.Agent 7.Family			24.Base 1				%		37.Softwood TG
2.Seller 5.Pub Rec 8.Other			25.Base 2				%		38.Mixed Wood TG
3.Lender 6.MLS 9.			26.Frontage 1				%		39.Hardwood TG
			27.Rear Land 4				%		40.Wasteland
			28.Rear Land 1				%		41.Commercial
			29.Rear Land 2				%		42.2nd Site
			Total Acreage		2.00				43.Post Rd
									44.Lot Improvemen
									45.Subdivision Lo
									46.Golf Course

Bowdoin

Map Lot 05-68-02

Account 1805

Location 4 KINFOLK LN

Card 1 Of 1 7/19/2022

Building Style	SF Bsmt Living	Layout
0.Not Code 4.Cape 8.Log	Fin Bsmt Grade	1.Typical 4. 7.
1.Conv. 5.Garrison 9.Other	OCCUPANCY	2.Inadeq 5. 8.
2.Ranch 6.Split 10.DW	Heat Type 100%	3.Poor 6. 9.
3.R Ranch 7.Contemp 11.Church	0.Not Code 4.Steam 8.FI/Wall	Attic
Dwelling Units	1.HWBB 5.FWA 9.No Heat	1.1/4 Fin 4.Full Fin 7.
Other Units	2.HWCI 6.GravWA 11.	2.1/2 Fin 5.FI/Stair 8.
Stories	3.H Pump 7.Electric 12.	3.3/4 Fin 6. 9.None
1.1 4.1.5 7.4	Cool Type 0%	Insulation
2.2 5.1.75 8.20	1.Refrig 4.W&C Air 7.	1.Full 4.Minimal 7.
3.3 6.2.5 9.Yurt	2.Evapor 5. 8.	2.Heavy 5. 8.
Exterior Walls	3.H Pump 6. 9.None	3.Capped 6. 9.None
0.Not Code 4.Asbestos 8.Concrete	Kitchen Style	Unfinished %
1.Wood 5.Stucco 9.Other	1.Modern 4.Obsolete 7.	Grade & Factor
2.Vin/Al 6.Brick 10.Board B	2.Typical 5. 8.	1.E Grade 4.B Grade 7.
3.Compos. 7.Stone 12.	3.Old Type 6. 9.None	2.D Grade 5.A Grade 8.
Roof Surface	Bath(s) Style	3.C Grade 6.AA Grade 9.Same
1.Asphalt 4.Composit 7.	1.Modern 4.Obsolete 7.	SQFT (Footprint)
2.Slate 5.Wood 8.	2.Typical 5. 8.	Condition
3.Metal 6.Other 9.	3.Old Type 6. 9.None	1.Poor 4.Avg 7.V G
SF Masonry Trim	# Rooms	2.Fair 5.Avg+ 8.Exc
SEPTIC DESIGN	# Bedrooms	3.Avg- 6.Good 9.Same
BLDG PERMIT	# Full Baths	Phys. % Good
Year Built	# Half Baths	Funct. % Good
Year Remodeled	# Addn Fixtures	Functional Code
Foundation	# Fireplaces	1.Incomp 4.Delap 7.No Power
1.Concrete 4.Wood 7.		2.O-Built 5.Bsmt 8.LongTerm
2.C Block 5.Slab 8.		3.Damage 6.Dbwd 9.None
3.Br/Stone 6.Piers 9.		Econ. % Good
Basement		Economic Code
1.1/4 Bmt 4.Full Bmt 7.		0.None 3.No Power 7.
2.1/2 Bmt 5.None 8.		1.Location 4.Generate 8.
3.3/4 Bmt 6. 9.None		2.Encroach 9.None 9.
Bsmt Gar # Cars		Entrance Code 5 Estimated
Wet Basement		1.Interior 4.Vacant 7.Entered
1.Dry 4. 7.		2.Refusal 5.Estimate 8.No
2.Damp 5. 8.	3.Informed 6.Reviewed 9.Land	
3.Wet 6. 9.	Information Code 6 Other	
	1.Owner 4.Agent 7.	
	2.Relative 5.Estimate 8.	
	3.Tenant 6.Other 9.	

140

520



Date Inspected 3/22/2012

Additions, Outbuildings & Improvements

Type	Year	Units	Grade	Cond	Phys.	Funct.	Sound Value
998 14Mobile Home	1986	14x52	3 100	3	0 %	100 %	
68 Wood Deck	1989	72	3 100	3	0 %	100 %	
68 Wood Deck	1989	72	3 100	3	0 %	100 %	
24 Frame Shed	1989	136	3 100	3	0 %	100 %	
73 M/H Skirting	1989	132	3 100	3	0 %	100 %	
					%	%	
					%	%	
					%	%	
					%	%	
					%	%	



- 1.One Story Fram
- 2.Two Story Fram
- 3.Three Story Fr
- 4.1 & 1/2 Story
- 5.1 & 3/4 Story
- 6.2 & 1/2 Story
- 21.Open Frame Por
- 22.Encl Frame Por
- 23.Attached Garag
- 24.Frame Shed
- 25.Frame Bay Wind
- 26.1SFr Overhang
- 27.Unfin Basement
- 28.Unfinished Att
- 29.Finished Attic

LETOURNEAU, RENE
LETOURNEAU, MARGUIERITE
PO BOX 115
LISBON FALLS ME 04252

B531P185

			Property Data			Assessment Record																																																																																																																																																																																		
			Neighborhood	5 Map 5		Year	Land	Buildings	Exempt	Total																																																																																																																																																																														
			Tree Growth Year 0			2009	109,100	82,770	10,000	181,870																																																																																																																																																																														
			Farmland Yr 0			2010	109,100	82,770	10,000	181,870																																																																																																																																																																														
			Open Space Yr 0			2011	109,100	82,770	10,000	181,870																																																																																																																																																																														
			Zone/Land Use 11 Residential 1			2012	109,100	82,770	10,000	181,870																																																																																																																																																																														
			Secondary Zone			2013	109,100	82,770	10,000	181,870																																																																																																																																																																														
			Topography			2014	109,100	82,770	10,000	181,870																																																																																																																																																																														
			1.Level 4.Below St 7.LevelBog			2015	98,600	82,080	10,000	170,680																																																																																																																																																																														
			2.Rolling 5.Low 8.Conform			2016	98,600	87,560	15,000	171,160																																																																																																																																																																														
			3.Above St 6.FZone 9.Non-Confor			2017	98,600	94,600	20,000	173,200																																																																																																																																																																														
			Utilities			2018	98,600	94,600	20,000	173,200																																																																																																																																																																														
			1.Public 4.Dr Well 7.Cesspool			2019	98,600	96,000	20,000	174,600																																																																																																																																																																														
			2.Water 5.Dug Well 8.			2020	98,600	96,000	25,000	169,600																																																																																																																																																																														
			3.Sewer 6.Septic 9.None			2021	98,600	96,000	25,000	169,600																																																																																																																																																																														
			Street 1 Paved			2022	98,600	95,200	21,500	172,300																																																																																																																																																																														
			1.Paved 4.Proposed 7.MHG			<table border="1"> <thead> <tr> <th colspan="6">Land Data</th> </tr> <tr> <th rowspan="2">Front Foot</th> <th rowspan="2">Type</th> <th colspan="2">Effective</th> <th colspan="2">Influence</th> <th rowspan="2">Influence Codes</th> </tr> <tr> <th>Frontage</th> <th>Depth</th> <th>Factor</th> <th>Code</th> </tr> </thead> <tbody> <tr> <td rowspan="15"> 11.Road Frontage 12.Delta Triangle 13.Nabla Triangle 14.Rear Land 15.Miscellaneous 16.Regular Lot 17.Secondary Lot 18.Hydro Facility 19.Improvements 20.Base 3 (Fract) </td> <td></td> <td></td> <td></td> <td></td> <td>%</td> <td>1.Unimproved</td> </tr> <tr> <td></td> <td></td> <td></td> <td></td> <td>%</td> <td>2.Excess Frtg</td> </tr> <tr> <td></td> <td></td> <td></td> <td></td> <td>%</td> <td>3.Topography</td> </tr> <tr> <td></td> <td></td> <td></td> <td></td> <td>%</td> <td>4.Size/Shape</td> </tr> <tr> <td></td> <td></td> <td></td> <td></td> <td>%</td> <td>5.Access</td> </tr> <tr> <td></td> <td></td> <td></td> <td></td> <td>%</td> <td>6.Restriction</td> </tr> <tr> <td></td> <td></td> <td></td> <td></td> <td>%</td> <td>7.Open Space</td> </tr> <tr> <td></td> <td></td> <td></td> <td></td> <td>%</td> <td>8.View/Environ</td> </tr> <tr> <td></td> <td></td> <td></td> <td></td> <td>%</td> <td>9.Fract Share</td> </tr> <tr> <td></td> <td></td> <td></td> <td></td> <td>%</td> <td>30.Rear Land 3</td> </tr> <tr> <td></td> <td></td> <td></td> <td></td> <td>%</td> <td>31.Tillable</td> </tr> <tr> <td></td> <td></td> <td></td> <td></td> <td>%</td> <td>32.Pasture</td> </tr> <tr> <td></td> <td></td> <td></td> <td></td> <td>%</td> <td>33.Orchard</td> </tr> <tr> <td></td> <td></td> <td></td> <td></td> <td>%</td> <td>34.Softwood F&O</td> </tr> <tr> <td></td> <td></td> <td></td> <td></td> <td>%</td> <td>35.Mixed Wood F&O</td> </tr> <tr> <td></td> <td></td> <td></td> <td></td> <td>%</td> <td>36.Hardwood F&O</td> </tr> <tr> <td></td> <td></td> <td></td> <td></td> <td>%</td> <td>37.Softwood TG</td> </tr> <tr> <td></td> <td></td> <td></td> <td></td> <td>%</td> <td>38.Mixed Wood TG</td> </tr> <tr> <td></td> <td></td> <td></td> <td></td> <td>%</td> <td>39.Hardwood TG</td> </tr> <tr> <td></td> <td></td> <td></td> <td></td> <td>%</td> <td>40.Wasteland</td> </tr> <tr> <td></td> <td></td> <td></td> <td></td> <td>%</td> <td>41.Commercial</td> </tr> <tr> <td></td> <td></td> <td></td> <td></td> <td>%</td> <td>42.2nd Site</td> </tr> <tr> <td></td> <td></td> <td></td> <td></td> <td>%</td> <td>43.Post Rd</td> </tr> <tr> <td></td> <td></td> <td></td> <td></td> <td>%</td> <td>44.Lot Improvemen</td> </tr> <tr> <td></td> <td></td> <td></td> <td></td> <td>%</td> <td>45.Subdivision Lo</td> </tr> <tr> <td></td> <td></td> <td></td> <td></td> <td>%</td> <td>46.Golf Course</td> </tr> </tbody> </table>					Land Data						Front Foot	Type	Effective		Influence		Influence Codes	Frontage	Depth	Factor	Code	11.Road Frontage 12.Delta Triangle 13.Nabla Triangle 14.Rear Land 15.Miscellaneous 16.Regular Lot 17.Secondary Lot 18.Hydro Facility 19.Improvements 20.Base 3 (Fract)					%	1.Unimproved					%	2.Excess Frtg					%	3.Topography					%	4.Size/Shape					%	5.Access					%	6.Restriction					%	7.Open Space					%	8.View/Environ					%	9.Fract Share					%	30.Rear Land 3					%	31.Tillable					%	32.Pasture					%	33.Orchard					%	34.Softwood F&O					%	35.Mixed Wood F&O					%	36.Hardwood F&O					%	37.Softwood TG					%	38.Mixed Wood TG					%	39.Hardwood TG					%	40.Wasteland					%	41.Commercial					%	42.2nd Site					%	43.Post Rd					%	44.Lot Improvemen					%	45.Subdivision Lo					%	46.Golf Course
			Land Data																																																																																																																																																																																					
Front Foot	Type	Effective		Influence		Influence Codes																																																																																																																																																																																		
		Frontage	Depth	Factor	Code																																																																																																																																																																																			
11.Road Frontage 12.Delta Triangle 13.Nabla Triangle 14.Rear Land 15.Miscellaneous 16.Regular Lot 17.Secondary Lot 18.Hydro Facility 19.Improvements 20.Base 3 (Fract)					%	1.Unimproved																																																																																																																																																																																		
					%	2.Excess Frtg																																																																																																																																																																																		
					%	3.Topography																																																																																																																																																																																		
					%	4.Size/Shape																																																																																																																																																																																		
					%	5.Access																																																																																																																																																																																		
					%	6.Restriction																																																																																																																																																																																		
					%	7.Open Space																																																																																																																																																																																		
					%	8.View/Environ																																																																																																																																																																																		
					%	9.Fract Share																																																																																																																																																																																		
					%	30.Rear Land 3																																																																																																																																																																																		
					%	31.Tillable																																																																																																																																																																																		
					%	32.Pasture																																																																																																																																																																																		
					%	33.Orchard																																																																																																																																																																																		
					%	34.Softwood F&O																																																																																																																																																																																		
					%	35.Mixed Wood F&O																																																																																																																																																																																		
				%	36.Hardwood F&O																																																																																																																																																																																			
				%	37.Softwood TG																																																																																																																																																																																			
				%	38.Mixed Wood TG																																																																																																																																																																																			
				%	39.Hardwood TG																																																																																																																																																																																			
				%	40.Wasteland																																																																																																																																																																																			
				%	41.Commercial																																																																																																																																																																																			
				%	42.2nd Site																																																																																																																																																																																			
				%	43.Post Rd																																																																																																																																																																																			
				%	44.Lot Improvemen																																																																																																																																																																																			
				%	45.Subdivision Lo																																																																																																																																																																																			
				%	46.Golf Course																																																																																																																																																																																			
			TG PLAN YEAR 0			<table border="1"> <thead> <tr> <th colspan="2">Square Foot</th> <th colspan="2">Square Feet</th> <th colspan="2">Acres/Sites</th> </tr> </thead> <tbody> <tr> <td>24</td> <td></td> <td>1.00</td> <td>100</td> <td>%</td> <td>0</td> </tr> <tr> <td>26</td> <td></td> <td>1.00</td> <td>100</td> <td>%</td> <td>0</td> </tr> <tr> <td>28</td> <td></td> <td>25.00</td> <td>100</td> <td>%</td> <td>0</td> </tr> <tr> <td>29</td> <td></td> <td>13.00</td> <td>100</td> <td>%</td> <td>0</td> </tr> <tr> <td>40</td> <td></td> <td>1.00</td> <td>100</td> <td>%</td> <td>0</td> </tr> <tr> <td>44</td> <td></td> <td>1.00</td> <td>100</td> <td>%</td> <td>0</td> </tr> <tr> <td>52</td> <td></td> <td>750.00</td> <td>100</td> <td>%</td> <td>0</td> </tr> <tr> <td colspan="2">Total Acreage</td> <td colspan="2">41.00</td> <td colspan="2"></td> </tr> </tbody> </table>					Square Foot		Square Feet		Acres/Sites		24		1.00	100	%	0	26		1.00	100	%	0	28		25.00	100	%	0	29		13.00	100	%	0	40		1.00	100	%	0	44		1.00	100	%	0	52		750.00	100	%	0	Total Acreage		41.00																																																																																																																											
			Square Foot		Square Feet						Acres/Sites																																																																																																																																																																													
24		1.00	100	%	0																																																																																																																																																																																			
26		1.00	100	%	0																																																																																																																																																																																			
28		25.00	100	%	0																																																																																																																																																																																			
29		13.00	100	%	0																																																																																																																																																																																			
40		1.00	100	%	0																																																																																																																																																																																			
44		1.00	100	%	0																																																																																																																																																																																			
52		750.00	100	%	0																																																																																																																																																																																			
Total Acreage		41.00																																																																																																																																																																																						
			Tif District # 0																																																																																																																																																																																					
			Sale Data																																																																																																																																																																																					
			Sale Date																																																																																																																																																																																					
			Price																																																																																																																																																																																					
			Sale Type																																																																																																																																																																																					
			1.Land 4.Mobile 7.C/I L&B																																																																																																																																																																																					
			2.L & B 5.Other 8.																																																																																																																																																																																					
			3.Building 6.C/I Land 9.																																																																																																																																																																																					
			Financing																																																																																																																																																																																					
			1.Convent 4.Seller 7.																																																																																																																																																																																					
			2.FHA/VA 5.Private 8.																																																																																																																																																																																					
			3.Assumed 6.Cash 9.Unknown																																																																																																																																																																																					
			Validity																																																																																																																																																																																					
			1.Valid 4.Split 7.Renovate																																																																																																																																																																																					
			2.Related 5.Partial 8.Other																																																																																																																																																																																					
			3.Distress 6.Exempt 9.Short																																																																																																																																																																																					
			Verified																																																																																																																																																																																					
			1.Buyer 4.Agent 7.Family																																																																																																																																																																																					
			2.Seller 5.Pub Rec 8.Other																																																																																																																																																																																					
			3.Lender 6.MLS 9.																																																																																																																																																																																					

Inspection Witnessed By:

X	Date	Description	Date Insp.

Notes:

Bowdoin

Bowdoin

Map Lot 05-69-0

Account 553

Location 15 ROBERTS RD

Card 1

Of 1

7/19/2022

Building Style 4 Cape Cod 0.Not Code 4.Cape 8.Log 1.Conv. 5.Garrison 9.Other 2.Ranch 6.Split 10.DW 3.R Ranch 7.Contemp 11.Church Dwelling Units 1 Other Units 0 Stories 4 One & 1/2 Story 1.1 4.1.5 7.4 2.2 5.1.75 8.20 3.3 6.2.5 9.Yurt Exterior Walls 1 Wood Siding 0.Not Code 4.Asbestos 8.Concrete 1.Wood 5.Stucco 9.Other 2.Vin/Al 6.Brick 10.Board B 3.Compos. 7.Stone 12. Roof Surface 3 Sheet Metal 1.Asphalt 4.Composit 7. 2.Slate 5.Wood 8. 3.Metal 6.Other 9. SF Masonry Trim 0 SEPTIC DESIGN 0 BLDG PERMIT 1514 Year Built 1992 Year Remodeled 0 Foundation 1 Concrete 1.Concrete 4.Wood 7. 2.C Block 5.Slab 8. 3.Br/Stone 6.Piers 9. Basement 5 Crawl Space 1.1/4 Bmt 4.Full Bmt 7. 2.1/2 Bmt 5.None 8. 3.3/4 Bmt 6. 9.None Bsmt Gar # Cars 0 Wet Basement 2 Damp Basement 1.Dry 4. 7. 2.Damp 5. 8. 3.Wet 6. 9.	SF Bsmt Living 0 Fin Bsmt Grade 0 0 OCCUPANCY 0 Heat Type 100% 9 Not Heated 0.Not Code 4.Steam 8.F/Wall 1.HWBB 5.FWA 9.No Heat 2.HWCI 6.GravWA 11. 3.H Pump 7.Electric 12. Cool Type 0% 9 None 1.Refrig 4.W&C Air 7. 2.Evapor 5. 8. 3.H Pump 6. 9.None Kitchen Style 2 Typical 1.Modern 4.Obsolete 7. 2.Typical 5. 8. 3.Old Type 6. 9.None Bath(s) Style 2 Typical Bath(s) 1.Modern 4.Obsolete 7. 2.Typical 5. 8. 3.Old Type 6. 9.None # Rooms 4 # Bedrooms 1 # Full Baths 1 # Half Baths 0 # Addn Fixtures 0 # Fireplaces 0	Layout 1 Typical 1.Typical 4. 7. 2.Inadeq 5. 8. 3.Poor 6. 9. Attic 9 None 1.1/4 Fin 4.Full Fin 7. 2.1/2 Fin 5.F/Stair 8. 3.3/4 Fin 6. 9.None Insulation 4 Minimal 1.Full 4.Minimal 7. 2.Heavy 5. 8. 3.Capped 6. 9.None Unfinished % 0% Grade & Factor 2 Fair 100% 1.E Grade 4.B Grade 7. 2.D Grade 5.A Grade 8. 3.C Grade 6.AA Grade 9.Same SQFT (Footprint) 532 Condition 3 Below Average 1.Poor 4.Avg 7.V G 2.Fair 5.Avg+ 8.Exc 3.Avg- 6.Good 9.Same Phys. % Good 95% Funct. % Good 100% Functional Code 9 None 1.Incomp 4.Delap 7.No Power 2.O-Built 5.Bsmt 8.LongTerm 3.Damage 6.Dbwd 9.None Econ. % Good 100% Economic Code None 0.None 3.No Power 7. 1.Location 4.Generate 8. 2.Encroach 9.None 9. Entrance Code 5 Estimated 1.Interior 4.Vacant 7.Entered 2.Refusal 5.Estimate 8.No 3.Informed 6.Reviewed 9.Land Information Code 5 Estimate 1.Owner 4.Agent 7. 2.Relative 5.Estimate 8. 3.Tenant 6.Other 9.
--	--	---

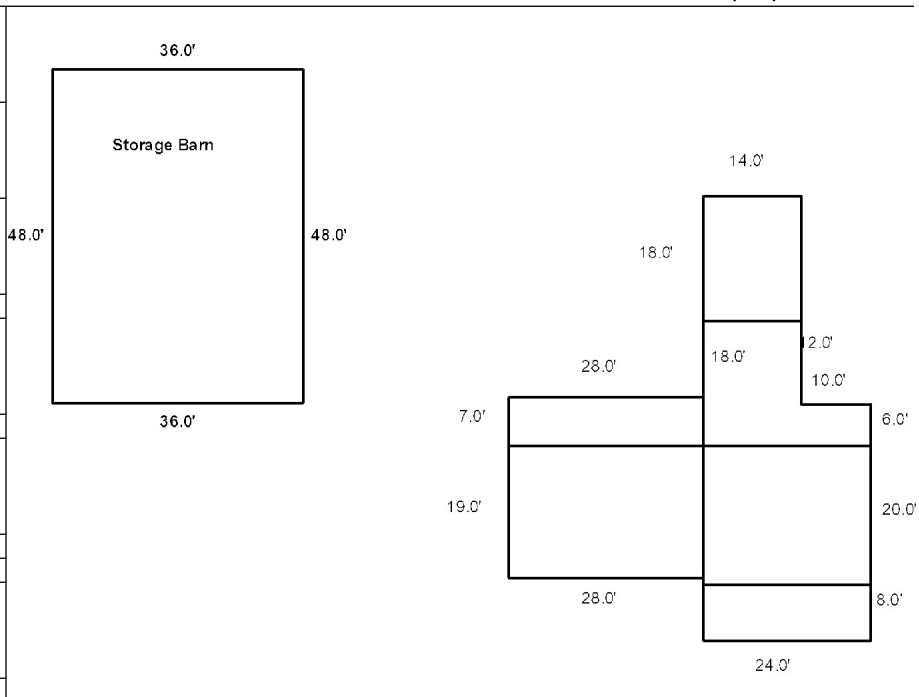

Date Inspected 3/27/2019

Additions, Outbuildings & Improvements

Type	Year	Units	Grade	Cond	Phys.	Funct.	Sound Value
1 One Story Frame	1945	480	2 100	2	0 %	80 %	
1 One Story Frame	1992	196	3 100	3	0 %	100 %	
21 Open Frame	1945	192	2 95	2	0 %	90 %	
1 One Story Frame	1945	312	2 95	2	0 %	90 %	
24 Frame Shed	1945	252	2 90	2	0 %	50 %	
24 Frame Shed	2015	1728	3 100	3	0 %	100 %	
					%	%	
					%	%	
					%	%	
					%	%	
					%	%	



Bowdoin

Map Lot 05-69-01

Account 554

Location 41 ROBERTS RD

Card 1 Of 1 7/19/2022

Building Style	SF Bsmt Living	Layout
0.Not Code 4.Cape 8.Log	Fin Bsmt Grade	1.Typical 4. 7.
1.Conv. 5.Garrison 9.Other	OCCUPANCY	2.Inadeq 5. 8.
2.Ranch 6.Split 10.DW	Heat Type 100%	3.Poor 6. 9.
3.R Ranch 7.Contemp 11.Church	0.Not Code 4.Steam 8.FI/Wall	Attic
Dwelling Units	1.HWBB 5.FWA 9.No Heat	1.1/4 Fin 4.Full Fin 7.
Other Units	2.HWCI 6.GravWA 11.	2.1/2 Fin 5.FI/Stair 8.
Stories	3.H Pump 7.Electric 12.	3.3/4 Fin 6. 9.None
1.1 4.1.5 7.4	Cool Type 0%	Insulation
2.2 5.1.75 8.20	1.Refrig 4.W&C Air 7.	1.Full 4.Minimal 7.
3.3 6.2.5 9.Yurt	2.Evapor 5. 8.	2.Heavy 5. 8.
Exterior Walls	3.H Pump 6. 9.None	3.Capped 6. 9.None
0.Not Code 4.Asbestos 8.Concrete	Kitchen Style	Unfinished %
1.Wood 5.Stucco 9.Other	1.Modern 4.Obsolete 7.	Grade & Factor
2.Vin/Al 6.Brick 10.Board B	2.Typical 5. 8.	1.E Grade 4.B Grade 7.
3.Compos. 7.Stone 12.	3.Old Type 6. 9.None	2.D Grade 5.A Grade 8.
Roof Surface	Bath(s) Style	3.C Grade 6.AA Grade 9.Same
1.Asphalt 4.Composit 7.	1.Modern 4.Obsolete 7.	SQFT (Footprint)
2.Slate 5.Wood 8.	2.Typical 5. 8.	Condition
3.Metal 6.Other 9.	3.Old Type 6. 9.None	1.Poor 4.Avg 7.V G
SF Masonry Trim	# Rooms	2.Fair 5.Avg+ 8.Exc
SEPTIC DESIGN	# Bedrooms	3.Avg- 6.Good 9.Same
BLDG PERMIT	# Full Baths	Phys. % Good
Year Built	# Half Baths	Funct. % Good
Year Remodeled	# Addn Fixtures	Functional Code
Foundation	# Fireplaces	1.Incomp 4.Delap 7.No Power
1.Concrete 4.Wood 7.	 <p>TRIO Software A Division of Harris Computer Systems</p>	2.O-Built 5.Bsmt 8.LongTerm
2.C Block 5.Slab 8.		3.Damage 6.Dbwd 9.None
3.Br/Stone 6.Piers 9.		Econ. % Good
Basement		Economic Code
1.1/4 Bmt 4.Full Bmt 7.		0.None 3.No Power 7.
2.1/2 Bmt 5.None 8.		1.Location 4.Generate 8.
3.3/4 Bmt 6. 9.None		2.Encroach 9.None 9.
Bsmt Gar # Cars		Entrance Code 3 Information Only
Wet Basement		1.Interior 4.Vacant 7.Entered
1.Dry 4. 7.		2.Refusal 5.Estimate 8.No
2.Damp 5. 8.	3.Informed 6.Reviewed 9.Land	
3.Wet 6. 9.	Information Code 1 Owner	
	1.Owner 4.Agent 7.	
	2.Relative 5.Estimate 8.	
	3.Tenant 6.Other 9.	

Date Inspected 4/21/2009

Additions, Outbuildings & Improvements

Type	Year	Units	Grade	Cond	Phys.	Funct.	Sound Value
68 Wood Deck	2005	128	3 100	3	0 %	100 %	
98 Frost Walls	2004	960	3 100	3	0 %	100 %	
992 Doublewide	2004	26x40	3 100	3	0 %	100 %	
					%	%	
					%	%	
					%	%	
					%	%	
					%	%	
					%	%	
					%	%	
					%	%	

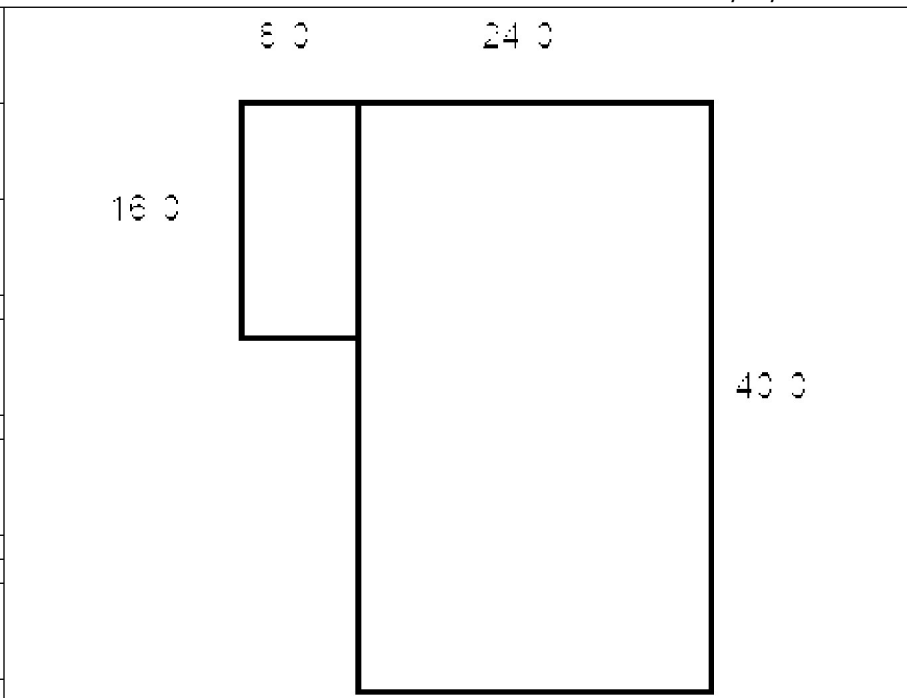

TOWLE, TRUSTEES OF DAVID L
 TOWLE, KATHERINE A
 55 ROBERTS RD
 BOWDOIN ME 04287

B1759P256

Inspection Witnessed By:

X	Date	Date Insp.
No./Date	Description	Date Insp.

Notes:

Bowdoin

Property Data			Assessment Record				
Neighborhood 5 Map 5			Year	Land	Buildings	Exempt	Total
Tree Growth Year 0			2009	47,640	61,550	0	109,190
Farmland Yr 0			2010	47,640	61,550	0	109,190
Open Space Yr 0			2011	47,640	61,550	0	109,190
Zone/Land Use 11 Residential 1			2012	47,640	61,550	0	109,190
Secondary Zone			2013	47,640	61,550	0	109,190
Topography			2014	47,640	61,550	0	109,190
1.Level 4.Below St 7.LevelBog			2015	47,640	61,550	0	109,190
2.Rolling 5.Low 8.Conform			2016	47,640	61,550	0	109,190
3.Above St 6.FZone 9.Non-Confor			2017	47,640	61,550	0	109,190
Utilities			2018	47,640	61,550	0	109,190
1.Public 4.Dr Well 7.Cesspool			2019	47,640	61,550	0	109,190
2.Water 5.Dug Well 8.			2020	47,640	61,550	0	109,190
3.Sewer 6.Septic 9.None			2021	47,640	61,550	0	109,190
Street 1 Paved			2022	47,640	58,880	0	106,520
1.Paved 4.Proposed 7.MHG			Land Data				
2.Semi Imp 5.R/O/W 8.DIS							
3.Gravel 6.MHP 9.None			Front Foot				
TG PLAN YEAR 0							
Tif District # 0			Type				
Sale Data							
Sale Date			Effective				
Price							
Sale Type			Influence				
1.Land 4.Mobile 7.C/I L&B							
2.L & B 5.Other 8.			Influence Codes				
3.Building 6.C/I Land 9.							
Financing			Square Foot				
1.Convent 4.Seller 7.							
2.FHA/VA 5.Private 8.			Square Feet				
3.Assumed 6.Cash 9.Unknown							
Validity			Fract. Acre				
1.Valid 4.Split 7.Renovate							
2.Related 5.Partial 8.Other			Acres				
3.Distress 6.Exempt 9.Short							
Verified			Acreege/Sites				
1.Buyer 4.Agent 7.Family							
2.Seller 5.Pub Rec 8.Other			Total Acreege 1.10				
3.Lender 6.MLS 9.							

- 1.Unimproved
- 2.Excess Frtg
- 3.Topography
- 4.Size/Shape
- 5.Access
- 6.Restriction
- 7.Open Space
- 8.View/Environ
- 9.Fract Share
- Acres**
- 30.Rear Land 3
- 31.Tillable
- 32.Pasture
- 33.Orchard
- 34.Softwood F&O
- 35.Mixed Wood F&O
- 36.Hardwood F&O
- 37.Softwood TG
- 38.Mixed Wood TG
- 39.Hardwood TG
- 40.Wasteland
- 41.Commercial
- 42.2nd Site
- 43.Post Rd
- 44.Lot Improvemen
- 45.Subdivision Lo
- 46.Golf Course

Bowdoin

Map Lot 05-69-02

Account 555

Location 51 ROBERTS RD

Card 1 Of 1 7/19/2022

Building Style 9 Other	SF Bsmt Living 0	Layout 1 Typical
0.Not Code 4.Cape 8.Log	Fin Bsmt Grade 0 0	1.Typical 4. 7.
1.Conv. 5.Garrison 9.Other	OCCUPANCY 0	2.Inadeq 5. 8.
2.Ranch 6.Split 10.DW	Heat Type 100% 1 Hot Water BB	3.Poor 6. 9.
3.R Ranch 7.Contemp 11.Church	0.Not Code 4.Steam 8.FI/Wall	Attic 9 None
Dwelling Units 1	1.HWBB 5.FWA 9.No Heat	1.1/4 Fin 4.Full Fin 7.
Other Units 0	2.HWCI 6.GravWA 11.	2.1/2 Fin 5.FI/Stair 8.
Stories 1 One Story	3.H Pump 7.Electric 12.	3.3/4 Fin 6. 9.None
1.1 4.1.5 7.4	Cool Type 0% 9 None	Insulation 1 Full
2.2 5.1.75 8.20	1.Refrig 4.W&C Air 7.	1.Full 4.Minimal 7.
3.3 6.2.5 9.Yurt	2.Evapor 5. 8.	2.Heavy 5. 8.
Exterior Walls 2 Vinyl/Aluminum	3.H Pump 6. 9.None	3.Capped 6. 9.None
0.Not Code 4.Asbestos 8.Concrete	Kitchen Style 2 Typical	Unfinished % 0%
1.Wood 5.Stucco 9.Other	1.Modern 4.Obsolete 7.	Grade & Factor 3 Average 100%
2.Vin/Al 6.Brick 10.Board B	2.Typical 5. 8.	1.E Grade 4.B Grade 7.
3.Compos. 7.Stone 12.	3.Old Type 6. 9.None	2.D Grade 5.A Grade 8.
Roof Surface 1 Asphalt Shingles	Bath(s) Style 2 Typical Bath(s)	3.C Grade 6.AA Grade 9.Same
1.Asphalt 4.Composit 7.	1.Modern 4.Obsolete 7.	SQFT (Footprint) 672
2.Slate 5.Wood 8.	2.Typical 5. 8.	Condition 4 Average
3.Metal 6.Other 9.	3.Old Type 6. 9.None	1.Poor 4.Avg 7.V G
SF Masonry Trim 0	# Rooms 5	2.Fair 5.Avg+ 8.Exc
SEPTIC DESIGN 0	# Bedrooms 2	3.Avg- 6.Good 9.Same
BLDG PERMIT 0	# Full Baths 1	Phys. % Good 0%
Year Built 2003	# Half Baths 0	Funct. % Good 100%
Year Remodeled 0	# Addn Fixtures 0	Functional Code 9 None
Foundation 5 Concrete Slab	# Fireplaces 0	1.Incomp 4.Delap 7.No Power
1.Concrete 4.Wood 7.	 <p>TRIO Software A Division of Harris Computer Systems</p>	2.O-Built 5.Bsmt 8.LongTerm
2.C Block 5.Slab 8.		3.Damage 6.Dbwd 9.None
3.Br/Stone 6.Piers 9.		Econ. % Good 100%
Basement 9 No Basement		Economic Code None
1.1/4 Bmt 4.Full Bmt 7.		0.None 3.No Power 7.
2.1/2 Bmt 5.None 8.		1.Location 4.Generate 8.
3.3/4 Bmt 6. 9.None		2.Encroach 9.None 9.
Bsmt Gar # Cars 0		Entrance Code 5 Estimated
Wet Basement 0		1.Interior 4.Vacant 7.Entered
1.Dry 4. 7.		2.Refusal 5.Estimate 8.No
2.Damp 5. 8.	3.Informed 6.Reviewed 9.Land	
3.Wet 6. 9.	Information Code 5 Estimate	
	1.Owner 4.Agent 7.	
	2.Relative 5.Estimate 8.	
	3.Tenant 6.Other 9.	

240

280

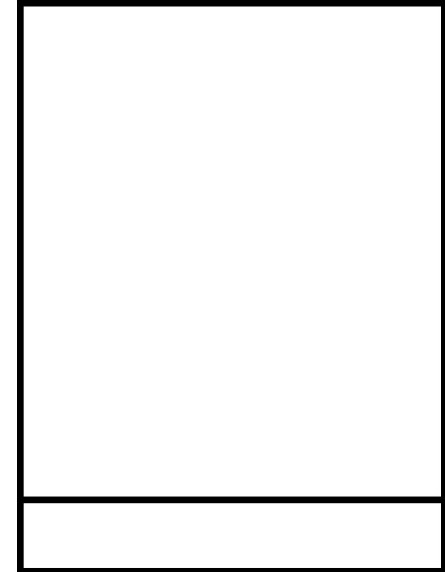

40

Date Inspected

Additions, Outbuildings & Improvements

Type	Year	Units	Grade	Cond	Phys.	Funct.	Sound Value
21 Open Frame	2003	96	0 0	0	0 %	0 %	
					%	%	
					%	%	
					%	%	
					%	%	
					%	%	
					%	%	
					%	%	
					%	%	
					%	%	
					%	%	
					%	%	
					%	%	
					%	%	
					%	%	
					%	%	
					%	%	
					%	%	
					%	%	
					%	%	



POMELOW, DAVID
P.O.. BOX 12
BOWDOIN ME 04287

B2506P302

Previous Owner
POMELOW, DONALD & ELAINE
PO BOX 202

LISBON FALLS ME 04252
Sale Date: 7/27/2004

Inspection Witnessed By:

X	Date	Description	Date Insp.

Notes:

Bowdoin

Property Data			Assessment Record				
Neighborhood 5 Map 5			Year	Land	Buildings	Exempt	Total
Tree Growth Year 0			2009	55,760	37,330	0	93,090
Farmland Yr 0			2010	55,760	34,280	0	90,040
Open Space Yr 0			2011	55,760	34,280	0	90,040
Zone/Land Use 11 Residential 1			2012	55,760	34,280	0	90,040
Secondary Zone			2013	55,760	34,280	0	90,040
Topography			2014	55,760	34,280	0	90,040
1.Level 4.Below St 7.LevelBog			2015	60,100	34,280	0	94,380
2.Rolling 5.Low 8.Conform			2016	52,930	34,280	0	87,210
3.Above St 6.FZone 9.Non-Confor			2017	52,930	34,280	0	87,210
Utilities			2018	52,930	34,280	0	87,210
1.Public 4.Dr Well 7.Cesspool			2019	52,930	34,280	0	87,210
2.Water 5.Dug Well 8.			2020	52,930	34,280	0	87,210
3.Sewer 6.Septic 9.None			2021	52,930	34,280	0	87,210
Street 1 Paved			2022	52,930	33,150	0	86,080
1.Paved 4.Proposed 7.MHG			Land Data				
2.Semi Imp 5.R/O/W 8.DIS							
3.Gravel 6.MHP 9.None			Front Foot				
TG PLAN YEAR 0							
Tif District # 0			Type				
Sale Data							
Sale Date			Effective				
Price							
Sale Type			Influence				
1.Land 4.Mobile 7.C/I L&B							
2.L & B 5.Other 8.			Influence Codes				
3.Building 6.C/I Land 9.							
Financing			Square Foot				
1.Convent 4.Seller 7.							
2.FHA/VA 5.Private 8.			Square Feet				
3.Assumed 6.Cash 9.Unknown							
Validity			Fract. Acre				
1.Valid 4.Split 7.Renovate							
2.Related 5.Partial 8.Other			Acres				
3.Distress 6.Exempt 9.Short							
Verified			Acres				
1.Buyer 4.Agent 7.Family							
2.Seller 5.Pub Rec 8.Other			Acres				
3.Lender 6.MLS 9.							

- 1.Unimproved
- 2.Excess Frtg
- 3.Topography
- 4.Size/Shape
- 5.Access
- 6.Restriction
- 7.Open Space
- 8.View/Environ
- 9.Fract Share
- Acres**
- 30.Rear Land 3
- 31.Tillable
- 32.Pasture
- 33.Orchard
- 34.Softwood F&O
- 35.Mixed Wood F&O
- 36.Hardwood F&O
- 37.Softwood TG
- 38.Mixed Wood TG
- 39.Hardwood TG
- 40.Wasteland
- 41.Commercial
- 42.2nd Site
- 43.Post Rd
- 44.Lot Improvemen
- 45.Subdivision Lo
- 46.Golf Course

Total Acreage 4.88

Bowdoin

Map Lot 05-69-03

Account 556

Location 881 MAIN ST

Card 1

Of 2

7/19/2022

Building Style 0 Not Coded	SF Bsmt Living 0	Layout 0
0.Not Code 4.Cape 8.Log	Fin Bsmt Grade 0 0	1.Typical 4. 7.
1.Conv. 5.Garrison 9.Other	OCCUPANCY 0	2.Inadeq 5. 8.
2.Ranch 6.Split 10.DW	Heat Type 100% 0 Not Coded	3.Pool 6. 9.
3.R Ranch 7.Contemp 11.Church	0.Not Code 4.Steam 8.FI/Wall	Attic 0
Dwelling Units 0	1.HWBB 5.FWA 9.No Heat	1.1/4 Fin 4.Full Fin 7.
Other Units 0	2.HWCI 6.GravWA 11.	2.1/2 Fin 5.FI/Stair 8.
Stories 0	3.H Pump 7.Electric 12.	3.3/4 Fin 6. 9.None
1.1 4.1.5 7.4	Cool Type 0% 9 None	Insulation 0
2.2 5.1.75 8.20	1.Refrig 4.W&C Air 7.	1.Full 4.Minimal 7.
3.3 6.2.5 9.Yurt	2.Evapor 5. 8.	2.Heavy 5. 8.
Exterior Walls 0 Not Coded	3.H Pump 6. 9.None	3.Capped 6. 9.None
0.Not Code 4.Asbestos 8.Concrete	Kitchen Style 0	Unfinished % 0%
1.Wood 5.Stucco 9.Other	1.Modern 4.Obsolete 7.	Grade & Factor 0 0%
2.Vin/Al 6.Brick 10.Board B	2.Typical 5. 8.	1.E Grade 4.B Grade 7.
3.Compos. 7.Stone 12.	3.Old Type 6. 9.None	2.D Grade 5.A Grade 8.
Roof Surface 0	Bath(s) Style 0	3.C Grade 6.AA Grade 9.Same
1.Asphalt 4.Composit 7.	1.Modern 4.Obsolete 7.	SQFT (Footprint) 0
2.Slate 5.Wood 8.	2.Typical 5. 8.	Condition 0
3.Metal 6.Other 9.	3.Old Type 6. 9.None	1.Poor 4.Avg 7.V G
SF Masonry Trim 0	# Rooms 0	2.Fair 5.Avg+ 8.Exc
SEPTIC DESIGN 0	# Bedrooms 0	3.Avg- 6.Good 9.Same
BLDG PERMIT 0	# Full Baths 0	Phys. % Good 0%
Year Built 0	# Half Baths 0	Funct. % Good 100%
Year Remodeled 0	# Addn Fixtures 0	Functional Code 9 None
Foundation 0	# Fireplaces 0	1.Incomp 4.Delap 7.No Power
1.Concrete 4.Wood 7.		2.O-Built 5.Bsmt 8.LongTerm
2.C Block 5.Slab 8.		3.Damage 6.Dbwd 9.None
3.Br/Stone 6.Piers 9.		Econ. % Good 100%
Basement 0		Economic Code None
1.1/4 Bmt 4.Full Bmt 7.		0.None 3.No Power 7.
2.1/2 Bmt 5.None 8.		1.Location 4.Generate 8.
3.3/4 Bmt 6. 9.None		2.Encroach 9.None 9.
Bsmt Gar # Cars 0		Entrance Code 3 Information Only
Wet Basement 0		1.Interior 4.Vacant 7.Entered
1.Dry 4. 7.		2.Refusal 5.Estimate 8.No
2.Damp 5. 8.		3.Informed 6.Reviewed 9.Land
3.Wet 6. 9.		Information Code 1 Owner
		1.Owner 4.Agent 7.
		2.Relative 5.Estimate 8.
		3.Tenant 6.Other 9.

Date Inspected 4/08/2016

Additions, Outbuildings & Improvements

Type	Year	Units	Grade	Cond	Phys.	Funct.	Sound Value
998 14Mobile Home	1988	14x66	3 100	3	0 %	100 %	
22 Encl Frame Porch	1983	144	3 100	3	0 %	100 %	
21 Open Frame	1983	252	3 100	3	0 %	100 %	
24 Frame Shed	0				%	%	1,000
24 Frame Shed	0				%	%	500
24 Frame Shed	0				%	%	50
24 Frame Shed	0				%	%	1,000
24 Frame Shed	0				%	%	750
72 M/H Basement	1983	924	3 100	4	0 %	100 %	
					%	%	

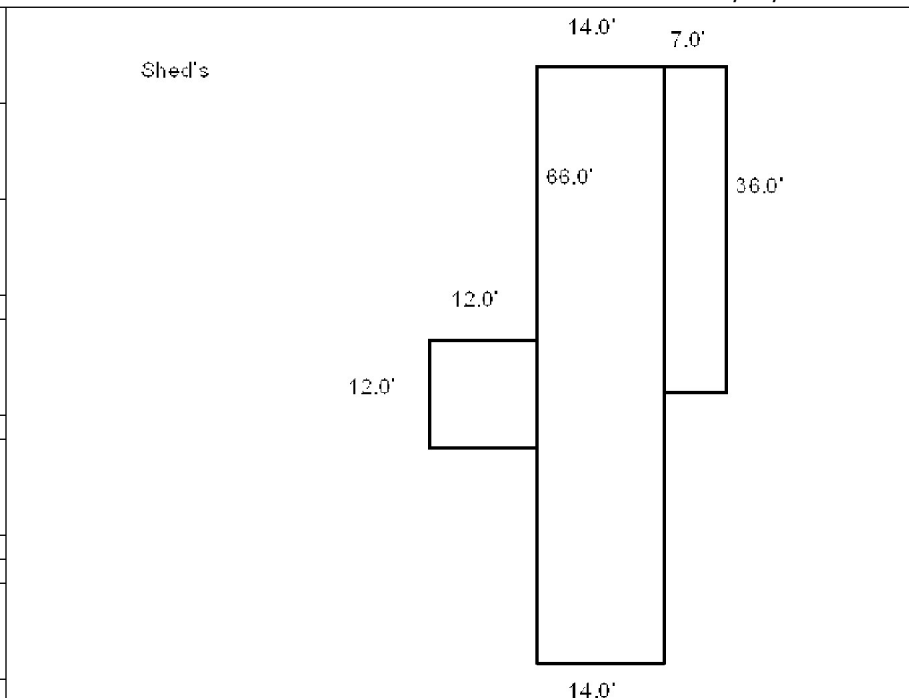

POMELOW, DAVID
P.O.. BOX 12
BOWDOIN ME 04287

B2506P302

Previous Owner
POMELOW, DONALD & ELAINE
PO BOX 202

LISBON FALLS ME 04252
Sale Date: 7/27/2004

Inspection Witnessed By:

No./Date	Description	Date Insp.
X		

Notes:

Bowdoin

Property Data			Assessment Record						
Neighborhood 5 Map 5			Year	Land	Buildings	Exempt	Total		
Tree Growth Year 0			2015	0	3,990	0	3,990		
Farmland Yr 0			2016	0	3,990	0	3,990		
Open Space Yr 0			2017	0	3,990	0	3,990		
Zone/Land Use 11 Residential 1			2018	0	3,990	0	3,990		
Secondary Zone			2019	0	3,990	0	3,990		
			2020	0	3,990	0	3,990		
Topography			2021	0	3,990	0	3,990		
1.Level 4.Below St 7.LevelBog 2.Rolling 5.Low 8.Conform 3.Above St 6.FZone 9.Non-Confor			2022	0	3,990	0	3,990		
Utilities									
1.Public 4.Dr Well 7.Cesspool 2.Water 5.Dug Well 8. 3.Sewer 6.Septic 9.None									
Street 1 Paved									
1.Paved 4.Proposed 7.MHG 2.Semi Imp 5.R/O/W 8.DIS 3.Gravel 6.MHP 9.None									
TG PLAN YEAR 0									
Tif District # 0									
Sale Data			Land Data						
Sale Date			Front Foot	Type	Effective		Influence		Influence Codes
Price					Frontage	Depth	Factor	Code	
Sale Type			11.Road Frontage						1.Unimproved
1.Land 4.Mobile 7.C/I L&B 2.L & B 5.Other 8. 3.Building 6.C/I Land 9.			12.Delta Triangle						2.Excess Frtg
Financing			13.Nabla Triangle						3.Topography
1.Convent 4.Seller 7. 2.FHA/VA 5.Private 8. 3.Assumed 6.Cash 9.Unknown			14.Rear Land						4.Size/Shape
Validity			15.Miscellaneous						5.Access
1.Valid 4.Split 7.Renovate 2.Related 5.Partial 8.Other 3.Distress 6.Exempt 9.Short									6.Restriction
Verified			Square Foot	Square Feet		Acres/Sites			7.Open Space
1.Buyer 4.Agent 7.Family 2.Seller 5.Pub Rec 8.Other 3.Lender 6.MLS 9.			16.Regular Lot						8.View/Environ
			17.Secondary Lot						9.Fract Share
			18.Hydro Facility						10.Acres
			19.Improvements						30.Rear Land 3
			20.Base 3 (Fract)						31.Tillable
			Fract. Acre	Acres/Sites					32.Pasture
			21.Base 1 (Fract)						33.Orchard
			22.Base 2 (Fract)						34.Softwood F&O
			23.Base 3						35.Mixed Wood F&O
			Acres	Acres/Sites					36.Hardwood F&O
			24.Base 1						37.Softwood TG
			25.Base 2						38.Mixed Wood TG
			26.Frontage 1						39.Hardwood TG
			27.Rear Land 4						40.Wasteland
			28.Rear Land 1						41.Commercial
			29.Rear Land 2						42.2nd Site
			Total Acreage 0.00						43.Post Rd
									44.Lot Improvemen
									45.Subdivision Lo
									46.Golf Course

Bowdoin

Map Lot 05-69-03

Account 556

Location 931 MAIN ST

Card 2 Of 2 7/19/2022

Building Style	SF Bsmt Living	Layout
0.Not Code 4.Cape 8.Log	Fin Bsmt Grade	1.Typical 4. 7.
1.Conv. 5.Garrison 9.Other	OCCUPANCY	2.Inadeq 5. 8.
2.Ranch 6.Split 10.DW	Heat Type 100%	3.Poor 6. 9.
3.R Ranch 7.Contemp 11.Church	0.Not Code 4.Steam 8.Fi/Wall	Attic
Dwelling Units	1.HWBB 5.FWA 9.No Heat	1.1/4 Fin 4.Full Fin 7.
Other Units	2.HWCI 6.GravWA 11.	2.1/2 Fin 5.Fi/Stair 8.
Stories	3.H Pump 7.Electric 12.	3.3/4 Fin 6. 9.None
1.1 4.1.5 7.4	Cool Type 0%	Insulation
2.2 5.1.75 8.20	1.Refrig 4.W&C Air 7.	1.Full 4.Minimal 7.
3.3 6.2.5 9.Yurt	2.Evapor 5. 8.	2.Heavy 5. 8.
Exterior Walls	3.H Pump 6. 9.None	3.Capped 6. 9.None
0.Not Code 4.Asbestos 8.Concrete	Kitchen Style	Unfinished %
1.Wood 5.Stucco 9.Other	1.Modern 4.Obsolete 7.	Grade & Factor
2.Vin/Al 6.Brick 10.Board B	2.Typical 5. 8.	1.E Grade 4.B Grade 7.
3.Compos. 7.Stone 12.	3.Old Type 6. 9.None	2.D Grade 5.A Grade 8.
Roof Surface	Bath(s) Style	3.C Grade 6.AA Grade 9.Same
1.Asphalt 4.Composit 7.	1.Modern 4.Obsolete 7.	SQFT (Footprint)
2.Slate 5.Wood 8.	2.Typical 5. 8.	Condition
3.Metal 6.Other 9.	3.Old Type 6. 9.None	1.Poor 4.Avg 7.V G
SF Masonry Trim	# Rooms	2.Fair 5.Avg+ 8.Exc
SEPTIC DESIGN	# Bedrooms	3.Avg- 6.Good 9.Same
BLDG PERMIT	# Full Baths	Phys. % Good
Year Built	# Half Baths	Funct. % Good
Year Remodeled	# Addn Fixtures	Functional Code
Foundation	# Fireplaces	1.Incomp 4.Delap 7.No Power
1.Concrete 4.Wood 7.		2.O-Built 5.Bsmt 8.LongTerm
2.C Block 5.Slab 8.		3.Damage 6.Dbwd 9.None
3.Br/Stone 6.Piers 9.		Econ. % Good
Basement		Economic Code
1.1/4 Bmt 4.Full Bmt 7.		0.None 3.No Power 7.
2.1/2 Bmt 5.None 8.		1.Location 4.Generate 8.
3.3/4 Bmt 6. 9.None		2.Encroach 9.None 9.
Bsmt Gar # Cars		Entrance Code 0
Wet Basement		1.Interior 4.Vacant 7.Entered
1.Dry 4. 7.		2.Refusal 5.Estimate 8.No
2.Damp 5. 8.	3.Informed 6.Reviewed 9.Land	
3.Wet 6. 9.	Information Code 0	
	1.Owner 4.Agent 7.	
	2.Relative 5.Estimate 8.	
	3.Tenant 6.Other 9.	

Date Inspected 4/08/2015

Additions, Outbuildings & Improvements

Type	Year	Units	Grade	Cond	Phys.	Funct.	Sound Value	
60 Capped	2015	1600	2 80	3	0 %	45 %		1.One Story Fram
					%	%		2.Two Story Fram
					%	%		3.Three Story Fr
					%	%		4.1 & 1/2 Story
					%	%		5.1 & 3/4 Story
					%	%		6.2 & 1/2 Story
					%	%		21.Open Frame Por
					%	%		22.Encl Frame Por
					%	%		23.Attached Garag
					%	%		24.Frame Shed
					%	%		25.Frame Bay Wind
					%	%		26.1SFr Overhang
					%	%		27.Unfin Basement
					%	%		28.Unfinished Att
					%	%		29.Finished Attic

POMELOW, DAVID C
 POMELOW, LORI
 P.O. BOX 12
 BOWDOIN ME 04287

B2015RP8628

Inspection Witnessed By:

No./Date	Description	Date Insp.
X		

Notes:

Bowdoin

Property Data			Assessment Record							
Neighborhood 5 Map 5			Year	Land	Buildings	Exempt	Total			
Tree Growth Year 0			2016	49,680	143,910	0	193,590			
Farmland Yr 0			2017	49,680	170,710	20,000	200,390			
Open Space Yr 0			2018	49,680	175,400	20,000	205,080			
Zone/Land Use 11 Residential 1			2019	49,680	211,580	20,000	241,260			
Secondary Zone			2020	49,680	214,300	25,000	238,980			
Topography			2021	49,680	219,750	25,000	244,430			
2022			49,680	219,750	21,500	247,930				
1.Level 4.Below St 7.LevelBog 2.Rolling 5.Low 8.Conform 3.Above St 6.FZone 9.Non-Confor										
Utilities										
1.Public 4.Dr Well 7.Cesspool 2.Water 5.Dug Well 8. 3.Sewer 6.Septic 9.None										
Street 1 Paved										
1.Paved 4.Proposed 7.MHG 2.Semi Imp 5.R/O/W 8.DIS 3.Gravel 6.MHP 9.None										
TG PLAN YEAR 0										
Tif District # 0										
Sale Data			Land Data							
Sale Date 11/10/2015			Front Foot	Type	Effective		Influence		Influence Codes	
Price					Frontage	Depth	Factor	Code		
Sale Type 1 Land Only				11.Road Frontage						1.Unimproved
1.Land 4.Mobile 7.C/I L&B 2.L & B 5.Other 8. 3.Building 6.C/I Land 9.				12.Delta Triangle						2.Excess Frtg
Financing 9 Unknown				13.Nabla Triangle						3.Topography
1.Convent 4.Seller 7. 2.FHA/VA 5.Private 8. 3.Assumed 6.Cash 9.Unknown			14.Rear Land					4.Size/Shape		
Validity 2 Related Parties			15.Miscellaneous					5.Access		
1.Valid 4.Split 7.Renovate 2.Related 5.Partial 8.Other 3.Distress 6.Exempt 9.Short								6.Restriction		
Verified 5 Public Record								7.Open Space		
1.Buyer 4.Agent 7.Family 2.Seller 5.Pub Rec 8.Other 3.Lender 6.MLS 9.								8.View/Environ		
			Square Foot	Square Feet				9.Fract Share		
			16.Regular Lot					10.Acres		
			17.Secondary Lot					30.Rear Land 3		
			18.Hydro Facility					31.Tillable		
			19.Improvements					32.Pasture		
			20.Base 3 (Fract)					33.Orchard		
								34.Softwood F&O		
			Fract. Acre	Acres/Sites				35.Mixed Wood F&O		
			21.Base 1 (Fract)	24	1.00	100	% 0	36.Hardwood F&O		
			22.Base 2 (Fract)	28	1.56	100	% 0	37.Softwood TG		
			23.Base 3	44	1.00	100	% 0	38.Mixed Wood TG		
			Acres	52	330.40	100	% 0	39.Hardwood TG		
			24.Base 1					40.Wasteland		
			25.Base 2					41.Commercial		
			26.Frontage 1					42.2nd Site		
			27.Rear Land 4					43.Post Rd		
			28.Rear Land 1					44.Lot Improvemen		
			29.Rear Land 2					45.Subdivision Lo		
				Total Acreage		2.56		46.Golf Course		

Bowdoin

Map Lot 05-69-04

Account 1853

Location 931 MAIN ST

Card 1 Of 1 7/19/2022

Building Style 2 Ranch	SF Bsmt Living 0	Layout 1 Typical
0.Not Code 4.Cape 8.Log	Fin Bsmt Grade 0 0	1.Typical 4. 7.
1.Conv. 5.Garrison 9.Other	OCCUPANCY 0	2.Inadeq 5. 8.
2.Ranch 6.Split 10.DW	Heat Type 100% 1 Hot Water BB	3.Poor 6. 9.
3.R Ranch 7.Contemp 11.Church	0.Not Code 4.Steam 8.FI/Wall	Attic 4 Full Finished
Dwelling Units 1	1.HWBB 5.FWA 9.No Heat	1.1/4 Fin 4.Full Fin 7.
Other Units 0	2.HWCI 6.GravWA 11.	2.1/2 Fin 5.FI/Stair 8.
Stories 1 One Story	3.H Pump 7.Electric 12.	3.3/4 Fin 6. 9.None
1.1 4.1.5 7.4	Cool Type 0% 9 None	Insulation 4 Minimal
2.2 5.1.75 8.20	1.Refrig 4.W&C Air 7.	1.Full 4.Minimal 7.
3.3 6.2.5 9.Yurt	2.Evapor 5. 8.	2.Heavy 5. 8.
Exterior Walls 2 Vinyl/Aluminum	3.H Pump 6. 9.None	3.Capped 6. 9.None
0.Not Code 4.Asbestos 8.Concrete	Kitchen Style 1 Modern	Unfinished % 0%
1.Wood 5.Stucco 9.Other	1.Modern 4.Obsolete 7.	Grade & Factor 3 Average 100%
2.Vin/Al 6.Brick 10.Board B	2.Typical 5. 8.	1.E Grade 4.B Grade 7.
3.Compos. 7.Stone 12.	3.Old Type 6. 9.None	2.D Grade 5.A Grade 8.
Roof Surface 1 Asphalt Shingles	Bath(s) Style 1 Modern Bath(s)	3.C Grade 6.AA Grade 9.Same
1.Asphalt 4.Composit 7.	1.Modern 4.Obsolete 7.	SQFT (Footprint) 1400
2.Slate 5.Wood 8.	2.Typical 5. 8.	Condition 4 Average
3.Metal 6.Other 9.	3.Old Type 6. 9.None	1.Poor 4.Avg 7.V G
SF Masonry Trim 0	# Rooms 0	2.Fair 5.Avg+ 8.Exc
SEPTIC DESIGN 0	# Bedrooms 2	3.Avg- 6.Good 9.Same
BLDG PERMIT 2014	# Full Baths 2	Phys. % Good 0%
Year Built 2016	# Half Baths 0	Funct. % Good 100%
Year Remodeled 0	# Addn Fixtures 0	Functional Code 9 None
Foundation 1 Concrete	# Fireplaces 0	1.Incomp 4.Delap 7.No Power
1.Concrete 4.Wood 7.	 <p>TRIO Software A Division of Harris Computer Systems</p>	2.O-Built 5.Bsmt 8.LongTerm
2.C Block 5.Slab 8.		3.Damage 6.Dbwd 9.None
3.Br/Stone 6.Piers 9.		Econ. % Good 100%
Basement 4 Full Basement		Economic Code None
1.1/4 Bmt 4.Full Bmt 7.		0.None 3.No Power 7.
2.1/2 Bmt 5.None 8.		1.Location 4.Generate 8.
3.3/4 Bmt 6. 9.None		2.Encroach 9.None 9.
Bsmt Gar # Cars 0		Entrance Code 0
Wet Basement 1 Dry Basement		1.Interior 4.Vacant 7.Entered
1.Dry 4. 7.		2.Refusal 5.Estimate 8.No
2.Damp 5. 8.	3.Informed 6.Reviewed 9.Land	
3.Wet 6. 9.	Information Code 0	
	1.Owner 4.Agent 7.	
	2.Relative 5.Estimate 8.	
	3.Tenant 6.Other 9.	

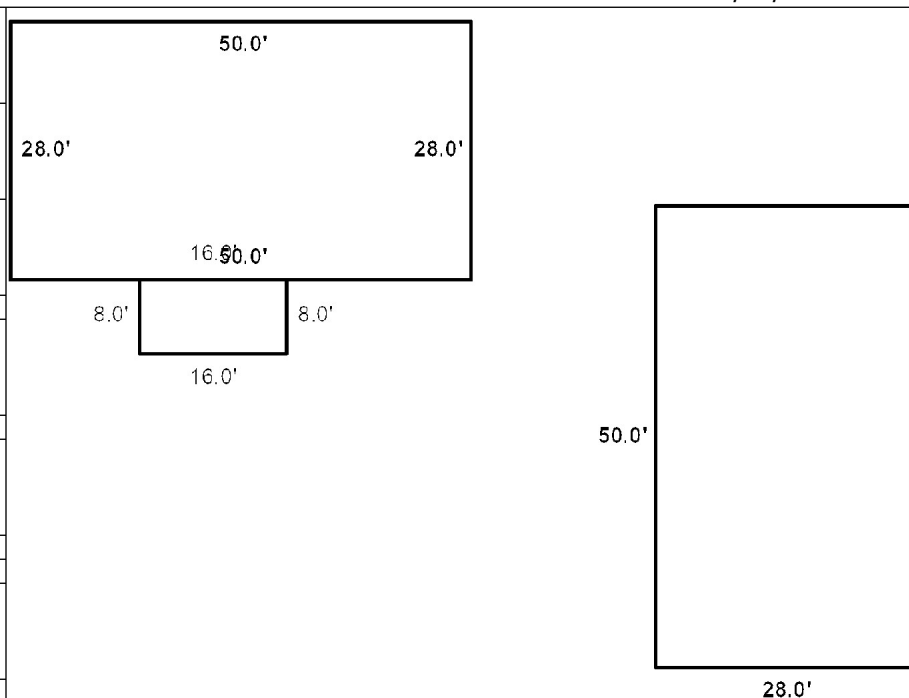

Date Inspected 4/30/2022

Additions, Outbuildings & Improvements

Type	Year	Units	Grade	Cond	Phys.	Funct.	Sound Value	
68 Wood Deck	2017	128	3 100	0	100 %	100 %		1.One Story Fram
68 Wood Deck	2017	128	3 100	0	100 %	100 %		2.Two Story Fram
91 1.5S Garage	2017	1400	3 100	0	100 %	90 %		3.Three Story Fr
					%	%		4.1 & 1/2 Story
					%	%		5.1 & 3/4 Story
					%	%		6.2 & 1/2 Story
					%	%		21.Open Frame Por
					%	%		22.Encl Frame Por
					%	%		23.Attached Garag
					%	%		24.Frame Shed
					%	%		25.Frame Bay Wind
					%	%		26.1SFr Overhang
					%	%		27.Unfin Basement
					%	%		28.Unfinished Att
					%	%		29.Finished Attic

GAYLEY, NORMA E
GAYLEY, JOHN W
34 ROBERTS RD
BOWDOIN ME 04287

B818P153

Property Data

Neighborhood	5 Map 5	
Tree Growth Year	0	
Farmland Yr	0	
Open Space Yr	0	
Zone/Land Use	11 Residential 1	
Secondary Zone		
Topography		
1.Level	4.Below St	7.LevelBog
2.Rolling	5.Low	8.Conform
3.Above St	6.FZone	9.Non-Confor
Utilities		
1.Public	4.Dr Well	7.Cesspool
2.Water	5.Dug Well	8.
3.Sewer	6.Septic	9.None
Street	1 Paved	
1.Paved	4.Proposed	7.MHG
2.Semi Imp	5.R/O/W	8.DIS
3.Gravel	6.MHP	9.None
TG PLAN YEAR	0	
Tif District #	0	

Assessment Record

Year	Land	Buildings	Exempt	Total
2009	48,200	131,910	10,000	170,110
2010	48,200	131,910	10,000	170,110
2011	48,200	131,910	10,000	170,110
2012	48,200	131,910	10,000	170,110
2013	48,200	131,910	10,000	170,110
2014	48,200	131,910	10,000	170,110
2015	48,200	131,910	10,000	170,110
2016	48,200	131,910	15,000	165,110
2017	48,200	131,910	20,000	160,110
2018	48,200	131,910	26,000	154,110
2019	48,200	131,910	26,000	154,110
2020	48,200	131,910	31,000	149,110
2021	48,200	131,910	31,000	149,110
2022	48,200	125,290	26,660	146,830

Land Data

Front Foot	Type	Effective		Influence		Influence Codes
		Frontage	Depth	Factor	Code	
11.Road Frontage				%		1.Unimproved
12.Delta Triangle				%		2.Excess Frtg
13.Nabla Triangle				%		3.Topography
14.Rear Land				%		4.Size/Shape
15.Miscellaneous				%		5.Access
				%		6.Restriction
				%		7.Open Space
				%		8.View/Environ
				%		9.Fract Share
Square Foot		Square Feet				Acres
16.Regular Lot				%		30.Rear Land 3
17.Secondary Lot				%		31.Tillable
18.Hydro Facility				%		32.Pasture
19.Improvements				%		33.Orchard
20.Base 3 (Fract)				%		34.Softwood F&O
				%		35.Mixed Wood F&O
	24		1.00	100 %	0	36.Hardwood F&O
	28		0.50	100 %	0	37.Softwood TG
	44		1.00	100 %	0	38.Mixed Wood TG
				%		39.Hardwood TG
				%		40.Wasteland
				%		41.Commercial
				%		42.2nd Site
				%		43.Post Rd
				%		44.Lot Improvemen
				%		45.Subdivision Lo
				%		46.Golf Course

Inspection Witnessed By:

X	Date	Date Insp.
No./Date	Description	

Notes:

Bowdoin

Bowdoin

Map Lot 05-70-0

Account 557

Location 34 ROBERTS RD

Card 1 Of 1 7/19/2022

Building Style 4 Cape Cod	SF Bsmt Living 0	Layout 1 Typical
0.Not Code 4.Cape 8.Log	Fin Bsmt Grade 0 0	1.Typical 4. 7.
1.Conv. 5.Garrison 9.Other	OCCUPANCY 0	2.Inadeq 5. 8.
2.Ranch 6.Split 10.DW	Heat Type 100% 1 Hot Water BB	3.Poor 6. 9.
3.R Ranch 7.Contemp 11.Church	0.Not Code 4.Steam 8.Fi/Wall	Attic 9 None
Dwelling Units 1	1.HWBB 5.FWA 9.No Heat	1.1/4 Fin 4.Full Fin 7.
Other Units 0	2.HWCI 6.GravWA 11.	2.1/2 Fin 5.Fi/Stair 8.
Stories 1 One Story	3.H Pump 7.Electric 12.	3.3/4 Fin 6. 9.None
1.1 4.1.5 7.4	Cool Type 0% 9 None	Insulation 1 Full
2.2 5.1.75 8.20	1.Refrig 4.W&C Air 7.	1.Full 4.Minimal 7.
3.3 6.2.5 9.Yurt	2.Evapor 5. 8.	2.Heavy 5. 8.
Exterior Walls 0 Not Coded	3.H Pump 6. 9.None	3.Capped 6. 9.None
0.Not Code 4.Asbestos 8.Concrete	Kitchen Style 2 Typical	Unfinished % 0%
1.Wood 5.Stucco 9.Other	1.Modern 4.Obsolete 7.	Grade & Factor 3 Average 100%
2.Vin/Al 6.Brick 10.Board B	2.Typical 5. 8.	1.E Grade 4.B Grade 7.
3.Compos. 7.Stone 12.	3.Old Type 6. 9.None	2.D Grade 5.A Grade 8.
Roof Surface 1 Asphalt Shingles	Bath(s) Style 2 Typical Bath(s)	3.C Grade 6.AA Grade 9.Same
1.Asphalt 4.Composit 7.	1.Modern 4.Obsolete 7.	SQFT (Footprint) 768
2.Slate 5.Wood 8.	2.Typical 5. 8.	Condition 4 Average
3.Metal 6.Other 9.	3.Old Type 6. 9.None	1.Poor 4.Avg 7.V G
SF Masonry Trim 0	# Rooms 6	2.Fair 5.Avg+ 8.Exc
SEPTIC DESIGN 0	# Bedrooms 3	3.Avg- 6.Good 9.Same
BLDG PERMIT 0	# Full Baths 2	Phys. % Good 0%
Year Built 1974	# Half Baths 0	Funct. % Good 100%
Year Remodeled 0	# Addn Fixtures 0	Functional Code 9 None
Foundation 1 Concrete	# Fireplaces 0	1.Incomp 4.Delap 7.No Power
1.Concrete 4.Wood 7.	 <p>TRIO Software A Division of Harris Computer Systems</p>	2.O-Built 5.Bsmt 8.LongTerm
2.C Block 5.Slab 8.		3.Damage 6.Dbwld 9.None
3.Br/Stone 6.Piers 9.		Econ. % Good 100%
Basement 4 Full Basement		Economic Code None
1.1/4 Bmt 4.Full Bmt 7.		0.None 3.No Power 7.
2.1/2 Bmt 5.None 8.		1.Location 4.Generate 8.
3.3/4 Bmt 6. 9.None		2.Encroach 9.None 9.
Bsmt Gar # Cars 0		Entrance Code 3 Information Only
Wet Basement 0		1.Interior 4.Vacant 7.Entered
1.Dry 4. 7.		2.Refusal 5.Estimate 8.No
2.Damp 5. 8.	3.Informed 6.Reviewed 9.Land	
3.Wet 6. 9.	Information Code 1 Owner	
		1.Owner 4.Agent 7.
		2.Relative 5.Estimate 8.
		3.Tenant 6.Other 9.

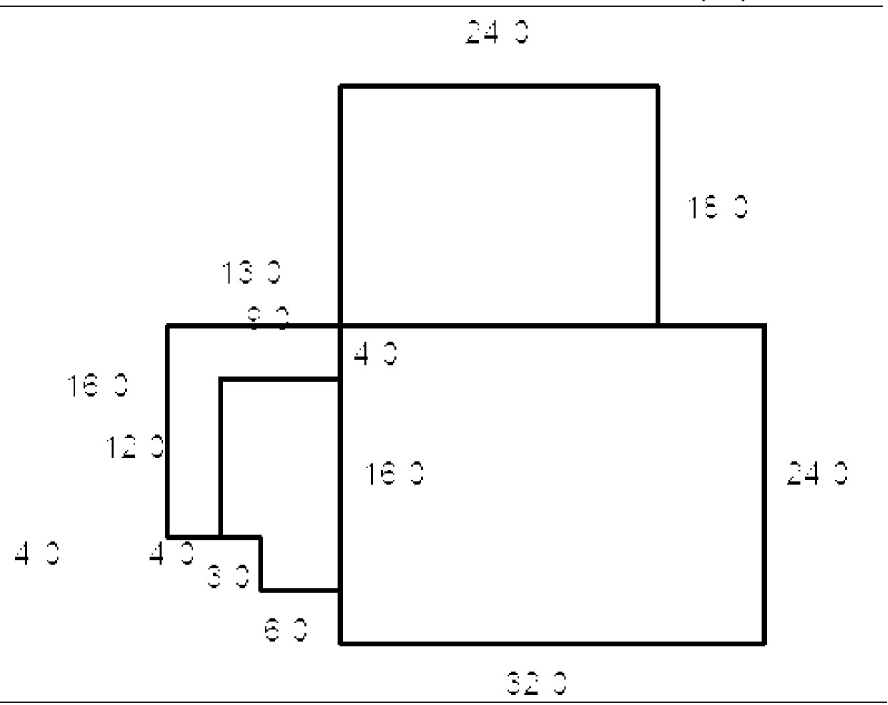

Date Inspected 3/15/2004

Additions, Outbuildings & Improvements

Type	Year	Units	Grade	Cond	Phys.	Funct.	Sound Value
5 1 & 3/4 Story Fr	1987	432	3 100	4	0 %	100 %	
68 Wood Deck	2003	122	3 100	4	0 %	100 %	
22 Encl Frame Porch	2003	132	3 100	4	0 %	100 %	
68 Wood Deck	2003	100	3 100	4	0 %	100 %	
30 Detached Garage	1977	400	3 100	4	0 %	100 %	
24 Frame Shed	1985	84	3 100	4	0 %	100 %	
62 Canopy	1985	316	3 100	4	0 %	100 %	
24 Frame Shed	1991	384	3 100	4	0 %	100 %	
					%	%	
					%	%	



- 1.One Story Fram
- 2.Two Story Fram
- 3.Three Story Fr
- 4.1 & 1/2 Story
- 5.1 & 3/4 Story
- 6.2 & 1/2 Story
- 21.Open Frame Por
- 22.Encl Frame Por
- 23.Attached Garag
- 24.Frame Shed
- 25.Frame Bay Wind
- 26.1SFr Overhang
- 27.Unfin Basement
- 28.Unfinished Att
- 29.Finished Attic